

Cam follower



CFUU IKO CFUUR

Roller diameter 10-90mm

- Axle mounted cam follower
- With synthetic rubber joints placed in the external ring
- Easy assembly with allen key (except for existing stock of older version)
- Diameter of housing 3 to 30mm, tolerance H7
- Material: carbon steel

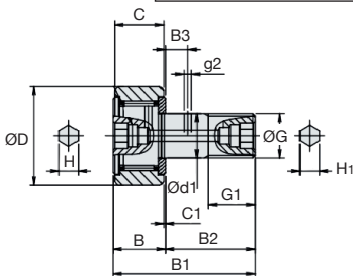
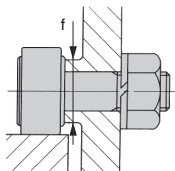
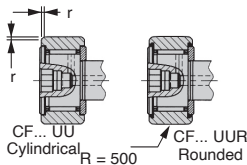

DISCOUNTS

Qty	1+	6+	10+	20+
Disc.	List	-20%	-25%	On request

Part number		Ød1 (h7)	ØD (h5)	C ^{+0,12}	ØG	ØG1	B	B1	B2	H	H1	Type	Price each. 1 to 5	
Crowned outer ring	Cylindrical outer ring													Type
CF3UUR	CF3UU	3	10	7	M3x0,5	5,0	8,0	17,0	9,0	2	-	-	34,63	33,32
CF4UUR	CF4UU	4	12	8	M4x0,7	6,0	9,0	20,0	11,0	2,5	-	-	31,79	33,32
CF5UUR	CF5UU	5	13	9	M5x0,8	7,5	10,0	23,0	13,0	3	-	-	28,58	27,47
CF6UUR	CF6UU	6	16	11	M6x1	8,0	12,2	28,2	16,0	3	-	-	24,23	24,23
CF8UUR	CF8UU	8	19	11	M8x1,25	10,0	12,2	32,2	20,0	4	-	-	25,27	25,27
CF10UUR	CF10UU	10	22	12	M10x1	12,0	13,2	36,2	23,0	4	5	✓	26,65	26,65
CF10-1UUR	CF10-1UU	10	26	12	M10x1	12,0	13,2	36,2	23,0	5	5	✓	28,27	28,27
CF12UUR	CF12UU	12	30	14	M12x1,5	13,0	15,2	40,2	25,0	6	6	✓	33,59	33,59
CF12-1UUR	CF12-1UU	12	32	14	M12x1,5	13,0	15,2	40,2	25,0	6	6	✓	35,43	35,43
CF16UUR	CF16UU	16	35	18	M16x1,5	17,0	19,6	52,1	32,5	6	8	✓	39,74	39,74
CF18UUR	CF18UU	18	40	20	M18x1,5	19,0	21,6	58,1	36,5	8	8	-	46,84	46,84
CF20UUR	CF20UU	20	52	24	M20x1,5	21,0	25,6	66,1	40,5	8	10	-	61,38	61,38
CF20-1UUR	CF20-1UU	20	47	24	M20x1,5	21,0	25,6	66,1	40,5	8	10	-	62,57	62,57
CF24UUR	CF24UU	24	62	29	M24x1,5	25,0	30,6	80,1	49,5	12	14	✓	90,14	90,14
CF24-1UUR	CF24-1UU	24	72	29	M24x1,5	25,0	30,6	80,1	49,5	12	14	-	100,73	100,73
CF30UUR	CF30UU	30	80	35	M30x1,5	32,0	37,0	100,0	63,0	17	14	-	131,54	131,54
CF30-1UUR	CF30-1UU	30	85	35	M30x1,5	32,0	37,0	100,0	63,0	17	14	-	154,43	154,43
CF30-2UUR	CF30-2UU	30	90	35	M30x1,5	32,0	37,0	100,0	63,0	17	14	-	155,47	155,47

*Depending on availability - Dimensions in mm

Info.

- (1) Max speed when lubricated with grease. For oil lubrication, the max speed is 30% higher. For cam followers with seals, the max speed is equivalent to 80% of this value.
- All the followers come with lubrication points: at the end of the axle on the roller side, on the threaded side, and on the cylindrical section, except for those models marked * which only have one hole on the roller side.
- Information given for the rails apply to all cam follower models.

Track capacity

Hardness (HRc)	Tensile strenght (N/mm ²)	Crowned outer ring	cylindrical outer ring
20	760	0,22	0,37
25	840	0,31	0,46
30	950	0,45	0,58
35	1080	0,65	0,75
38	1180	0,85	0,89
40	1250	1,00	1,00
42	1340	1,23	1,15
44	1435	1,52	1,32
46	1530	1,85	1,51
48	1635	2,27	1,73
50	1760	2,80	1,99
52	1880	3,46	2,29
54	2015	4,21	2,61
56	2150	5,13	2,97
58	2290	6,26	3,39

Crowned type part number	Track capacity (N)	Crowned type part number	Track capacity (N)	Cylindrical type part number	Track capacity (N)	Cylindrical type part number	Track capacity (N)	Miniature cam follower	Track capacity (N)
CF3R	-	CF16	3060	CF3	1360	CF16	11200	CFS2,5	298
CF4R	-	CF18	3660	CF4	1790	CF18	14500	CFS3	485
CF5R	-	CF20	5190	CF5	2210	CF20	23200	CFS4	799
CF6R	1 040	CF20-1R	4530	CF6	3400	CF20-1	21000	CFS5	1210
CF8R	1330	CF24R	6580	CF8	4040	CF24	34300	CFS6	1680
CF10R	1610	CF24-1R	8020	CF10	4680	CF24-1	39800	-	-
CF10-1R	2030	CF30R	9220	CF10-1	5530	CF30	52700	-	-
CF12R	2470	CF30-1R	9990	CF12	7010	CF30-1	56000	-	-
CF12-1R	2710	CF30-2R	10800	CF12-1	7480	CF30-2	59300	-	-

Part number	B3	C1	g1	g2	r mini	Min. flange Ø f (mm)	Max. tightening torque (Nm)	Basic dynamic load C (N)	Basic static load C (N)	Max. allowable load (N)	Max speed (1) (rpm)	Weight (g)
CF3UU	-	0,5	-	-	0,2	6,8	0,40	1500	1020	384	50000	4,3
CF4UU	-	0,5	-	-	0,3	8,3	0,78	2070	1590	834	34000	7,4
CF5UU	-	0,5	-	-	0,3	9,3	1,60	2520	2140	1260	38000	10,3
CF6UU	-	0,6	-	-	0,3	11,0	2,70	3660	3650	1950	22000	18,5
CF8UU	-	0,6	-	-	0,3	13,0	6,50	4250	4740	4620	17000	28,5
CF10UU	-	0,6	-	-	0,3	16,0	13,80	5430	6890	6890	14000	45,0
CF10-1UU	-	0,6	-	-	0,3	16,0	13,80	5430	6890	6890	14000	60,0
CF12UU	6	0,6	4	3	0,6	21,0	21,90	7910	9790	9790	11000	95,0
CF12-1UU	6	0,6	4	3	0,6	21,0	21,90	7910	9790	9790	11000	105,0
CF16UU	8	0,8	4	3	1,0	26,0	58,50	12000	18300	18300	8500	170,0
CF18UU	8	0,8	6	3	1,0	29,0	86,20	14800	25200	25200	7000	250,0
CF20UU	9	0,8	6	4	1,0	34,0	119,00	20700	34600	34600	6500	460,0
CF20-1UU	9	0,8	6	4	1,0	34,0	119,00	20700	34600	34600	6500	385,0
CF24UU	11	0,8	6	4	1,0	40,0	215,00	30500	52600	52000	5500	815,0
CF24-1UU	11	0,8	6	4	1,0	40,0	215,00	30500	52600	52000	5500	1140,0
CF30UU	15	1,0	6	4	1,0	49,0	438,00	45400	85100	85100	4000	1870,0
CF30-1UU	15	1,0	6	4	1,0	49,0	438,00	45400	85100	85100	4000	2030,0
CF30-2UU	15	1,0	6	4	1,0	49,0	438,00	45400	85100	85100	4000	2220,0

Dimensions in mm

Our other products



MRASSeco

Low cost stainless steel quick link, Stainless steel



RNAST

Cam follower without axial guide, Without interior ring



M2

Worm and wheel set, Unhardened steel

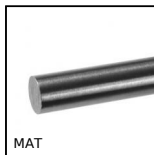

MAT

Drawn ground round bar, 100C6 steel bar



BSM

Spring plunger with internal hexagonal socket, stainless steel 303 b...



PGNT

Thermoplastic T handle, With threaded spindle



B_ECO

Eco. range steel bevel gear, 1:1



BOXbeta

Box of assorted hitch pins, Boxed set - hitch



GE14

Toggle latches, With padlock-holder



PTCR

Adjustable furniture foot, square tube



PV1R

Adjustable suction-cup support, Standard grip



AFM

Flanged polymer bush, Food grade polymer

Complementary products



CFS

Miniature cam follower, Miniature