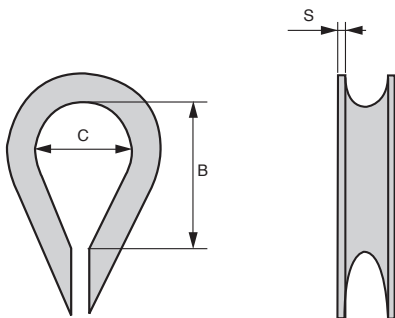

- Fitting elements
- Wire thimble for use with CAB/SS stainless steel cable
- Material:  
Stainless steel AISI 316

**Info.**

- Sold by the packet

**DISCOUNTS**

Qty	1+	30+	60+	90+	120+	150+
Disc.	List	-5%	-10%	-15%	-20%	On request

Part number	Cable Ø	C	B	S	Weight (g)	Stock*	Price each 1 to 29
CCL-2/SS	2	9	15	1	2,00	✓	0,49 €
CCL-3/SS	3	10	17	1	2,40	✓	0,62 €
CCL-4/SS	4	11	18	1	3,80	✓	0,76 €
CCL-5/SS	5	12	22	1	4,80	✓	1,19 €
CCL-6/SS	6	13	24	1	5,00	✓	1,27 €

\*Depending on availability - Dimensions in mm

## Our other products



R206

Die spring ISO10243,  
Extra-heavy



TCL-ECL

Adjusting nut, Fine  
thread



CNA-CNG

Right angled  
mounting plate, Right  
angled mounting  
plate for clevis



BLH70

Right angled gearbox,  
from 26 to 128 Nm



PR40

Articulated foot Ø50,  
Ø 50



BC2

Panamech, Multi-  
Beam, Aluminium -  
with clamping jaw



GE32

Sprung toggle latch  
with connecting link,  
Standard



INS\_SS

Self tapping stainless  
steel insert, 316  
stainless steel



SLH-M

Nut for toggle clamp,  
Round ended nut for



ZBconique

Machined plastic  
bevel gear, 1:1



PAS

Pull handle,  
Reinforced PA



CHAR7520

Spring hinge, screwed

## Complementary products

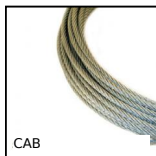

CAB

Stainless steel cable,  
Stainless steel



SCA\_SS

Stainless steel flat  
cable clamp, Stainless  
steel



SCA\_SS

Stainless steel flat  
cable clamp, Stainless  
steel



CABPVC

PVC covered  
galvanised steel  
cable, Galvanised  
steel with

