

# Cylindrical elasto mount

Ste Stock

B-ZY

Male / female mounting

- Radial elasticity greater than axial elasticity
- Cylinder worked under compression or shearing
- Materials  
core: Steel plates  
cylinder: Rubber
- Hardness: NK 55-60 shore A
- Working temp: -40°C to +70°C

## Uses

- Dampens sound and vibrations

## Info.

- Not sold individually, please contact us for details
- Values for loads and rigidity are given as a guide only

From  
size M3  
upwards

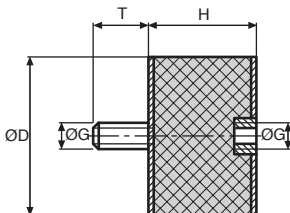

## DISCOUNTS A

Qty	1+	6+	20+	40+	100+	200+
Disc.	List	-10%	-15%	-20%	-25%	On request

## DISCOUNTS B

Qty	1+	6+	10+	15+	20+	50+
Disc.	List	-10%	-15%	-20%	-25%	On request

Part number	ØG	ØD	H	T	Compression		Shearing		Stock*	Price each 1 to 5
					stiffness (N/mm)	Max. load (N)	stiffness (N/mm)	Max. load (N)		
B-ZY3-8-8	M3	8	8	6	-	-	-	-	✓	A 4,03 €
B-ZY4-10-10	M4	10	10	10	48	43	10	35	✓	A 2,06 €
B-ZY4-10-15	M4	10	15	10	29	43	5	15	✓	A 2,19 €
B-ZY4-15-15	M4	15	15	10	67	95	15	35	✓	A 2,06 €
B-ZY4-15-20	M4	15	20	10	-	-	-	-	✓	A 2,16 €
B-ZY4-15-30	M4	15	30	15	-	-	-	-	✓	A 2,30 €
B-ZY5-15-15	M5	15	15	8	67	95	15	35	✓	A 2,16 €
B-ZY6-20-15	M6	20	15	18	130	170	24	60	✓	A 2,40 €
B-ZY6-20-20	M6	20	20	18	-	-	-	-	✓	A 2,39 €
B-ZY6-20-25	M6	20	25	18	61	170	11	60	✓	A 2,50 €
B-ZY6-25-15	M6	25	15	18	-	-	-	-	✓	A 2,73 €
B-ZY6-25-20	M6	25	20	18	130	280	30	95	✓	A 3,07 €
B-ZY6-25-25	M6	25	25	18	-	-	-	-	✓	A 3,17 €
B-ZY6-25-30	M6	25	30	18	71	280	19	95	✓	A 3,42 €
B-ZY8-30-15	M8	30	15	20	525	400	58	140	✓	A 3,75 €
B-ZY8-30-20	M8	30	20	20	235	400	42	140	✓	A 3,99 €
B-ZY8-30-25	M8	30	25	20	-	-	-	-	✓	A 4,33 €
B-ZY8-30-30	M8	30	30	20	113	400	28	140	✓	A 4,64 €
B-ZY8-30-40	M8	30	40	20	106	400	13	140	✓	A 5,21 €
B-ZY8-40-25	M8	40	25	23	-	-	-	-	✓	A 5,24 €
B-ZY8-40-30	M8	40	30	23	234	650	49	250	✓	A 5,89 €
B-ZY8-40-40	M8	40	40	23	147	650	23	250	✓	A 6,78 €
B-ZY10-40-30	M10	40	30	28	-	-	-	-	✓	A 6,34 €
B-ZY10-50-20	M10	50	20	28	857	1000	110	400	✓	A 7,68 €
B-ZY10-50-25	M10	50	25	28	-	-	-	-	✓	A 8,92 €
B-ZY10-50-30	M10	50	30	28	395	1000	73	400	✓	A 8,50 €
B-ZY10-50-40	M10	50	40	28	273	1000	58	400	✓	A 8,69 €
B-ZY10-50-45	M10	50	45	28	-	-	-	-	✓	A 8,90 €
B-ZY10-50-50	M10	50	50	28	210	1000	37	400	✓	A 9,51 €
B-ZY10-60-40	M10	60	40	28	-	-	-	-	✓	A 12,82 €
B-ZY10-70-45	M10	70	45	28	-	-	-	-	✓	A 19,25 €
B-ZY12-60-40	M12	60	40	33	-	-	-	-	✓	B 8,48 €
B-ZY12-75-25	M12	75	25	37	-	-	-	-	✓	B 0,00 €
B-ZY12-75-40	M12	75	40	37	735	2300	118	850	✓	B 0,25 €
B-ZY12-75-50	M12	75	50	37	530	2300	101	850	-	B 12,98 €
B-ZY12-75-55	M12	75	55	37	417	2300	78	850	-	B 13,52 €
B-ZY16-100-40	M16	100	40	41	2160	4200	283	1600	-	B 20,34 €
B-ZY16-100-55	M16	100	55	41	892	4200	145	1600	-	B 23,11 €
B-ZY16-100-60	M16	100	60	41	843	4200	142	1600	-	B 24,27 €
B-ZY16-100-75	M16	100	75	41	-	-	-	-	-	B 30,52 €

\*Depending on availability - Dimensions in mm

## Our other products



GE  
Toggle latches,  
Miniature



HW\_HT  
Half-rail guide, Rail

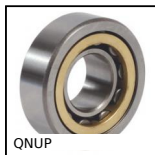

QNUP  
Single row cylindrical  
roller bearing, 1 fixed  
inner flange and 1 fr...



NPTF20  
Fixed tube carrier,  
Fixed Ø10 to Ø14



MSP38  
Masterplate®  
glueable insert Ø38,  
Cylindrical Ø38 with  
threaded s...



RT25ss  
Self-centering flanged  
locking assembly,  
Medium/high torque



BIM  
Indexing plunger mini,  
miniature



GAL21  
Conveyor wheel,  
Plastic



LC  
Friction clutch, 190 to  
1800 Nm



BABam  
Self-locking ball pin  
lifting ring for  
threaded hole, Self-



T5P\_T10P  
Connecting plate for T  
type timing belts, T10



SH1  
Parallel axis helical  
gear, Machined plastic  
(delrin)

## Complementary products



BZY\_SS  
Stainless steel  
cylindrical elasto  
mount, Stainless steel



AZY  
Cylindrical elasto  
mount, Steel



AZY\_SS  
Stainless steel  
cylindrical elasto  
mount, Stainless steel



CTZY  
Diabolo shaped elasto  
mount, Steel