

BPVM

Fluid displacement

- **Ball caster for positioning and aligning parts**
- The ball rolls durably on the sliding bearing
- The surface of the part is preserved
- Working temperature: -50°C to +90°C
- The load capacity decreases linearly at temperatures > 20°C.
(Example: at 90°C, the load capacity is 60% max.)
- Materials:
Burnished steel screw and steel ball bearing
Plain bearing: polyurethane

Applications

- Enables low-friction guidance
- ⚠ **Not suitable for indexing!**

Advantage

- Adjusting the position of the carrier ball from the rear.

NEW !

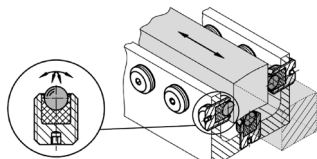
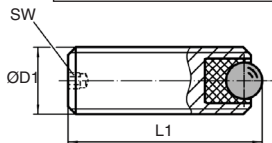

Typical application

DISCOUNTS

Qty	1+	6+	20+	40+	60+
Disc. Price	-10%	-15%	-20%	On request	

Part number	ØD1	L1	Ball ØD	SW	Max. tightening torque (Nm)	Max load capacity for static use (N)	Weight (g)	Price each 1 to 5
BPVM6-8	M6	8	2,5	1,5	0,1	172	1	13,35 €
BPVM6-16	M6	16	2,5	1,5	0,1	172	3	13,35 €
BPVM8-10	M8	10	3,5	1,5	0,3	336	3	13,43 €
BPVM8-20	M8	20	3,5	1,5	0,3	336	7	13,43 €
BPVM10-12	M10	12	4,5	2,0	0,6	556	5	13,54 €
BPVM10-25	M10	25	4,5	2,0	0,6	556	13	13,54 €
BPVM12-16	M12	16	6,5	2,5	1,4	1161	10	14,14 €
BPVM12-35	M12	35	6,5	2,5	1,4	1161	27	14,14 €
BPVM16-20	M16	20	8,5	3,0	3,2	1986	24	16,98 €
BPVM16-50	M16	50	8,5	3,0	3,2	1986	71	16,98 €

Dimensions in mm

- **Ball caster for positioning and orienting parts**
- The ball rolls durably on the sliding bearing
- The surface of the part is preserved
- Working temperature: -50°C to +90°C
- The load capacity decreases linearly at temperatures > 20°C..
(Example: at 90°C, the load capacity is 60% max.)

- Materials:

Screw stainless steel 303 hardened stainless steel ball

Plain bearing: polyurethane

Applications

- Enables low-friction guidance
- ⚠ **Not suitable for indexing!**

Advantage

- Adjusting the position of the carrier ball from the rear.

NEW!
Stainless Steel

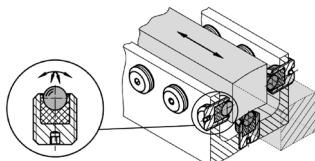
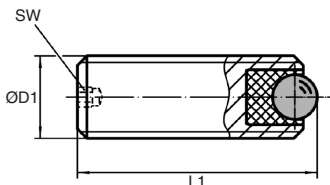

Typical application

DISCOUNTS

Qty	1+	6+	20+	40+	60+
Disc.	Price	-10%	-15%	-20%	On request

Part number	Ball		Max. tightening torque (Nm)	Max load capacity for static use (N)	Weight (g)	Price each 1 to 5		
	ØD1	L1					ØD	SW
BPVM6-8/SS	M6	8	2,5	1,5	0,1	172	1	18,72 €
BPVM6-16/SS	M6	16	2,5	1,5	0,1	172	3	18,72 €
BPVM8-10/SS	M8	10	3,5	1,5	0,3	336	3	18,83 €
BPVM8-20/SS	M8	20	3,5	1,5	0,3	336	7	18,83 €
BPVM10-12/SS	M10	12	4,5	2,0	0,6	556	5	18,96 €
BPVM10-25/SS	M10	25	4,5	2,0	0,6	556	13	18,96 €
BPVM12-16/SS	M12	16	6,5	2,5	1,4	1161	10	19,81 €
BPVM12-35/SS	M12	35	6,5	2,5	1,4	1161	27	19,81 €
BPVM16-20/SS	M16	20	8,5	3,0	3,2	1986	24	23,78 €
BPVM16-50/SS	M16	50	8,5	3,0	3,2	1986	71	23,78 €

Dimensions in mm

Mini plain bearing ball transfer unit New Size XS

BPPL

For countersinking

- **Plain bearing ball caster**
- Maintenance free
- Working temperature: -50°C to +90°C
- The load capacity decreases linearly at temperatures > 20°C.
(Example: at 90°C, the load capacity is 60% max.)
- Materials:
 - Case: Stainless steel
 - Plan bearing: polyurethane
 - Ball: Hardened stainless steel

Advantage

- The knurled outside allows easy fitting into the holes of additional preparation.

Assembly

- Fastening is done by pushing the carrier ball with knurled outside
- The carrier balls can be fitted with **BPPL/TOOL** mounting tools.

Application

- Transport, conveyor, workstation and packaging systems.

NEW!

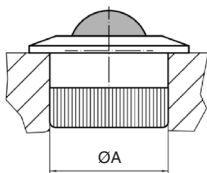
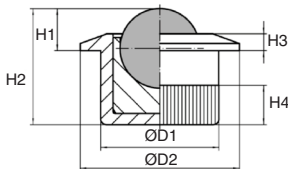

Mounting tool

DISCOUNTS

Qty	1+	6+	20+	40+	60+
Disc. Price	-10%	-15%	-20%	On request	

Part number	Ball		ØA		Load capacity		Weight		Price each		
	ØD	ØD1	ØD2	H1	H2	H3	H4	(H7)	(kg)	(g)	1 to 5

Mini carrier ball

BPPL6-10	6,5	10,0	13	3,2	11,2	1,2	4,2	10,0	116	4	12,29 €
BPPL8-12	8,5	12,6	17	4,5	12,4	1,8	4,2	12,6	198	8	13,35 €

Mounting tool

BPPL6-10/TOOL	For carrier ball BPPL6-10		118		25,42 €
BPPL8-12/TOOL	For carrier ball BPPL8-12		125		25,42 €

Dimensions in mm

Our other products



F7-SF-SM

Multifunction display,
Mounting bracket for
front mounting

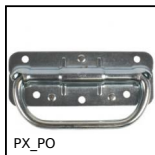

PX_PO

Carrying handle, back-
plated

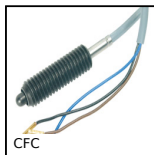

CFC

Spring loaded position
switch, Electric
contact



SHWbr

Washer - DIN125,
Brass



TFR

Rigid manual
tensioner, Fixed



PCS8ECO

Chain sprocket - steel,
8mm (DIN 05B-1)



CHML50

Worm and wheel gear
reducer, up to 107
Nm - Integrated
torque limiter



CHA_GC_9SS

Stainless steel garnet
hinge, To be welded



UCFL_SS

Stainless steel flanged
bearing, Stainless



BOXKU

Boxed set of half
round (Woodruff) keys



T10_30_AL

T type timing pulley,
Economy range - T10



PF40

Worm and wheel gear
reducer, up to 18 Nm

Complementary products



BPVM

Miniature ball transfer
unit, Miniature to
screw



BPVMss

Stainless steel
miniature ball transfer
unit, Miniature to
screw



BPPL

Mini plain bearing ball
transfer unit, For
countersinking