

# Flange mounting ball transfer unit

Plastic

BPPE

- **Plastic ball mounting ball transfer unit**
- Push fit for rapid installation & replacement where only single-sided access to the mounting surface is available
- Clips compensate for irregularities in seat bore diameter
- Max. speed: 1m/s
- Working temperature range: -20 to +70°C
- Materials:  
Acetal body and balls (POM)

## Advantages

- Resists salt water and chemical attacks
- Non-conductive and non-magnetic
- Suitable for antimicrobial applications
- For use in chemical, pharmaceutical and medical applications

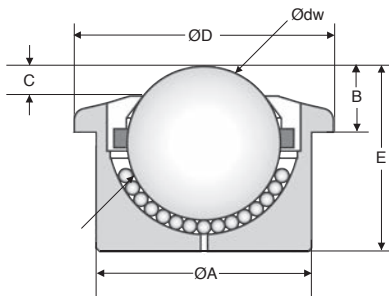

## DISCOUNTS

Qty	1+	6+	20+	40+	60+
Disc.	Net	-10%	-15%	-20%	On request

Part N°	Ødw ball	ØA	B	C	ØD	E	Carrying capacity (kg)	Weight (g)	Price each 1 to 5
BPPE15-24/PP	15	24	8,0	4,8	30	20,0	7	0,010	18,29 €
BPPE22-36/PP	22	36	9,8	4,5	45	30,5	10	0,035	27,43 €
BPPE30-45/PP	30	45	13,8	5,8	55	37,0	15	0,065	32,65 €
BPPE45-62/PP	45	62	19,0	8,5	75	53,5	20	0,182	72,36 €

All dimensions in mm

**0 825 88 6000**  
Service 0,15 € / min  
+ prix appel

Fax

cial2@hpceurope.com

**HPC**

SUPPLEMENT 2019

255

## Our other products



**BTC\_M**  
End cap with threaded insert for square tube,  
With threaded insert



**PHT**  
Pull handle, Up to 250 °C



**ACL-PL**  
Joining plate for aluminium profile,  
Joint plate - 86x86 mm



**LC**  
Friction clutch, 190 to 1800 Nm



**PPCss**  
Pad eye on mounting plate squarred,  
Stainless steel



**SLB**  
Indexing plunger,  
steel class 5.8



**BLHB50**  
Right angled gearbox,  
bored shafts, up to 30 Nm

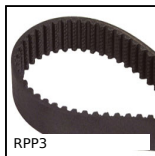

**RPP3**  
RPP heavy duty timing belt, RPP3



**PW\_PWG25**  
Worm - precision range, Steel



**BDPR**  
Holding arm, Rigid



**CHM110**  
Worm and wheel gear reducer, up to 980 Nm



**PR65C**  
Half-articulated foot Ø 65, Ø 65

## Complementary products



**BPHFclip**  
Clip for ball transfer unit, Insert clip -  
Installing from above



**BPLE**  
Ball transfer unit push fit, Light



**BPHF**  
Ball transfer unit push fit, Heavy



**BPHF**  
Ball transfer unit push fit, Heavy