

# Flange mounting ball transfer unit

Plastic

BPPE

- **Plastic ball mounting ball transfer unit**
- Push fit for rapid installation & replacement where only single-sided access to the mounting surface is available
- Clips compensate for irregularities in seat bore diameter
- Max. speed: 1m/s
- Working temperature range: -20 to +70°C
- Materials:  
Acetal body and balls (POM)

## Advantages

- Resists salt water and chemical attacks
- Non-conductive and non-magnetic
- Suitable for antimicrobial applications
- For use in chemical, pharmaceutical and medical applications

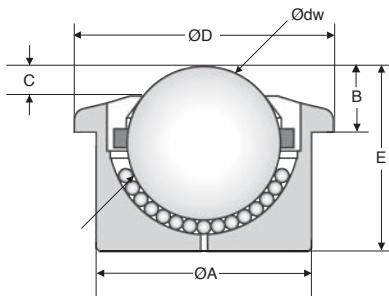

## DISCOUNTS

|       |     |      |      |      |            |
|-------|-----|------|------|------|------------|
| Qty   | 1+  | 6+   | 20+  | 40+  | 60+        |
| Disc. | Net | -10% | -15% | -20% | On request |

| Part N°      | Ødw<br>ball | ØA | B    | C   | ØD | E    | Carrying<br>capacity<br>(kg) | Weight<br>(g) | Price each<br>1 to 5 |
|--------------|-------------|----|------|-----|----|------|------------------------------|---------------|----------------------|
| BPPE15-24/PP | 15          | 24 | 8,0  | 4,8 | 30 | 20,0 | 7                            | 0,010         | 18,29 €              |
| BPPE22-36/PP | 22          | 36 | 9,8  | 4,5 | 45 | 30,5 | 10                           | 0,035         | 27,43 €              |
| BPPE30-45/PP | 30          | 45 | 13,8 | 5,8 | 55 | 37,0 | 15                           | 0,065         | 32,65 €              |
| BPPE45-62/PP | 45          | 62 | 19,0 | 8,5 | 75 | 53,5 | 20                           | 0,182         | 72,36 €              |

All dimensions in mm

**0 825 88 6000**  
Service 0,15 € / min  
+ prix appel

Fax

cial2@hpceurope.com

**HPC**

SUPPLEMENT 2019

255

## Our other products



MEB  
Moulded plastic bevel gear (nylon), 1:1



MHSC  
Single-disc flexible coupling, Single disk



CCL  
Standard wire thimble, Steel



DILC  
Indexing plunger with cam, with cam



BLHB50  
Right angled gearbox, bored shafts, up to 30 Nm



PM4  
Worm and wheel set, Hardened steel



FF50  
Offset spur gear reducer, from 111 to 425 Nm



PRES  
Manual workbench press accessory with PRES-3HR end PRES-4HR, Micromet...



VTA  
Vari-Tork® slip friction clutch, 0.53 to 1.32 Nm



Q4  
Double row radial contact ball bearing, Radial contact - Steel



ACL-PLAngle  
Joining plate for aluminium profile, Angle connection



BSP  
Compact precision slide, from 156 N to 980 N

## Complementary products



BPHFclip  
Clip for ball transfer unit, Insert clip - Installing from above



BPLE  
Ball transfer unit push fit, Light



BPHF  
Ball transfer unit push fit, Heavy



BPHF  
Ball transfer unit push fit, Heavy