

Stainless steel slotted spring plunger

BPMc

With ceramic ball tip

- **Positioning and locating screw**

- **Materials:**

Body: Stainless steel 303, natural finish

Spring: Stainless steel

Ball: Ceramic (Si3N4)

stainless steel



Info

- Use of a Si3N4 ceramic offers high resistance and grip, is hard wearing and is chemically resistant.

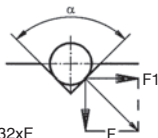

$$\alpha = 60^\circ, F1 = 1,732xF$$

$$\alpha = 90^\circ, F1 = F$$

$$\alpha = 120^\circ, F1 = 0,577xF$$

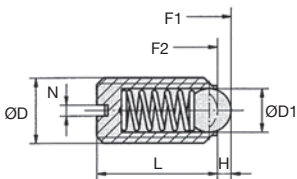

DISCOUNTS

Qty	1+	6+	20+	50+	100+	250+	400+
Disc. List		-5%	-10%	-15%	-30%	-50%	On request

Part number	ØD	ØD1	L	H	N	Pressure (N)		Weight (g)	Price each
						Initial F1	Final F2		
BPM5SS/C	M5	3	12	0,9	0,8	6	11	0,9	4,97 €
BPM6SS/C	M6	3,5	14	1	1	9	13	1,5	4,97 €
BPM8SS/C	M8	5	16	1,5	1,2	15	30	3,5	6,73 €
BPM10SS/C	M10	6	19	2	1,6	20	35	7	7,69 €
BPM12SS/C	M12	8	22	2,5	2	30	55	10	11,82 €
BPM16SS/C	M16	10	24	3,5	2,5	65	125	24	14,84 €

Dimensions in mm

Our other products



SUA4
Single chain supplied by the metre, Steel



PRF_SDD
Support for Ø12mm Prox detector, Ø12



H1
Crossed helical gear crossed axis at 90°, Steel 20NCD2



G4
Steel spur gear, Steel 20NCD2



DB
Steel bevel gear, 2:1



NT63
Spur gear coaxial gearbox, from 8 to 20 Nm - Inline

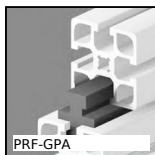

PRF-GPA
Guide for aluminium profile, Parallel rails



PTAF80-PAMF80
Articulated fixable foot with pressed base Ø80, Ø 80



HTD8M_20
HTD Heavy duty timing pulley, HTD8 Cast



CHAE4080PA
Symetrical decorative screwed hinge, Polyamide



B_ECO
Eco. range steel bevel gear, 1:1



T10_21_AL
T type timing pulley, Economy range - T10 aluminium

Complementary products



BPM-Z
Plastic slotted spring plunger with ball tip, Plastic body + staine...



BPM
Slotted spring plunger with ball tip, Stainless steel 303



BPM_LOK
Long-Lok slotted spring plunger with ball tip, LONG-LOK - Steel



BPM_LOK
Long-Lok slotted spring plunger with ball tip, LONG-LOK - Stainless ...