

High profile ball transfer unit

BPLF

For light loads

- **Pressed steel ball transfer unit with mounting plate**
- With 2 or 4 mounting holes for screws or rivets.
(The BPLF25-55-2F has 2 slots rather than 2 holes to accommodate different centre distances)
- For light loads
- Housing made from pressed steel
- With drainage hole and felt seal.
- Orientation: horizontal with ball upwards
- Max. speed: 1m/s
- Working temperature range: -20 to +70°C
- Materials:

BPL:galvanised steel body and steel balls

BPL/SS:stainless steel body and stainless steel
420 balls

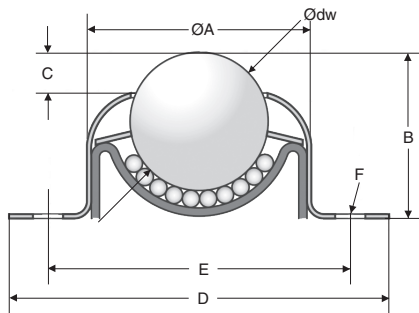

DISCOUNTS

Qty	1+	6+	20+	40+	60+
Disc. Prix		-10%	-15%	-20%	On request

Part N°	Ødw ball	ØA	B	C	D	E	F	Carrying capacity (kg)	Weight (kg)	Price each 1 to 5
Steel body, steel balls										
BPLF25-45-2F	25,4	45,0	30,4	6,3	69 x 51	55,9 - 60,3	Fente 2 x 5,5 x 7,7	55	0,155	✓ 5,84 €
BPLF38-67-4	38,1	66,9	46,2	9,8	76,2 x 76,2	62,7 x 62,7	4 x Ø7,1	115	0,520	- 17,65 €
Stainless steel body / Stainless steel ball										
BPLF25-45-2F/SS	25,4	45,0	30,4	6,3	69 x 51	55,9 - 60,3	Fente 2 x 5,5 x 7,7	55	0,151	✓ 15,21 €

*Depending on availability - Dimensions in mm

Our other products



DILC

Indexing plunger with cam, with cam



BCH_SS

Mushroom headed button, M3 to M8



RJA00_28

Sealing strip, Clipping



DOMI80

Accessories, Fixing kit



BPM-Z

Plastic slotted spring plunger with ball tip, Plastic body + stainless steel tip



DOG316

Motor-gearbox 12V and 24V DC, from 1.5 to 2 Nm



CHA135

Screwed hinge, 135 degrees



R203

Die spring ISO10243, Light



TRM

Spur round rack, Steel - module 1-6



MFBS

Stainless steel flexible bellows coupling, Stainless steel - with



GE_ES

Spherical bushing, Steel / steel



PDD

Actuating plunger, Non-rotating detector shaft

Complementary products



BPL

Ball transfer unit light duty, Light



BPLE

Ball transfer unit push fit, Light



BPLF

Ball transfer unit light duty, Light