



Right angled gearbox, dual output shafts

Torque up to 128Nm

BLHM70

- Input and two outputs have a reversed sens of direction
- Ratios of 1:1 to 2:1
- Output backlash $\approx 1^\circ$
- Max. speed: 4,000 rpm
- Materials: casing: anodised aluminium
input: hardened steel,
output: hardened steel
- Weight: 8.76 kg

Options

- Can be modified to your specifications

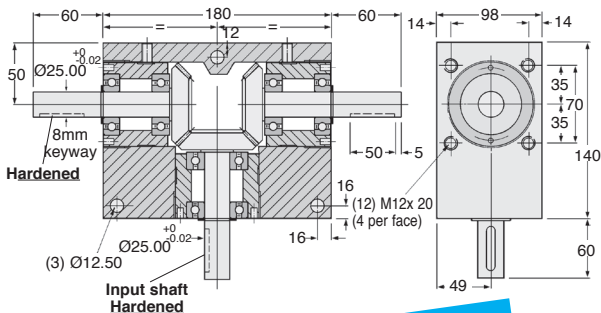
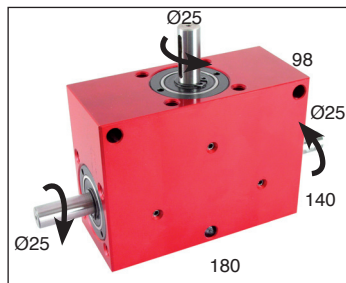

Output torque Nm (Nm values given as a guide only)

Ratios	1:1	2:1
3000	43	26
2000	47	30
INPUT 1000	51	34
SPEED 500	64	38
(rpm) 100	85	51
50	94	60
10	128	77

Innovative !
Outputs rotate in
different directions

DISCOUNTS

Qty	1+	2+	4+
Disc.	List	-15%	On request

Part number	Ratio	Efficiency at 1000 rpm	Max. input speed (rpm)	Max. output speed (rpm)	Module	Price each
BLHM70-1	1:1	88%	3000	3000	4,0	On request
BLHM70-2	2:1	88%	3000	1500	2,5	On request

Dimensions in mm

Our other products



RFK58C
Hypoid gearbox -
Stainless steel, up to
500 Nm



KH
Linear bearing, Light



PRES3HR
Manual workbench
press, Force up to
400kg

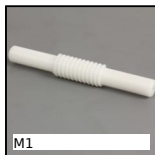

M1
Worm and wheel set,
Machined plastic
(delrin)



BFDdII
Locking pin for
bushes, Nickel-plated
steel



BAGSS
Stainless steel
Clamping collar,
Stainless steel



BPLE
Ball transfer unit push
fit, Light



AZY
Cylindrical elasto
mount, Steel



CHMR75
Worm and wheel gear
reducer, up to 298
Nm



HTD8M_50
HTD Heavy duty
timing pulley, HTD8
Steel



EHD16
Internal epicyclic
servo reducers, from
210 to 380 Nm



ZA
Shaft for linear
guides, Hardened
ground steel

Complementary products



BLH70
Right angled gearbox,
from 26 to 128 Nm



BLHT70
Right angled gearbox,
from 26 to 128 Nm