

Single housed bearing assembly

BH02 Bearing retained by with circlips

- **Bearing mounted in housing with circlips**
- Housing supplied with bearing
- ZZ bearing (with shielding)
- **Materials:**
Housing: zinc plated steel (60C40), natural finish
Bearing: steel
Circlips: steel

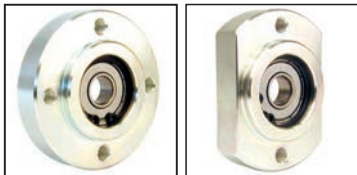

Options

- Flange with bearing glued in (BH01)

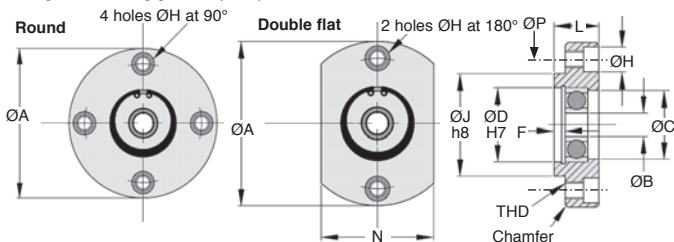

Part number			ØB	ØD	ØC	L	ØA	ØP
Round	Double flat	Square						
BH0200-40-623	BH0201-40-623	BH0202-40-623	3	Ø10x7Deep	Ø8,5	11	40	30
BH0200-40-634	BH0201-40-634	BH0202-40-634	4	Ø16x8Deep	Ø14,0	11	40	30
BH0200-40-625	BH0201-40-625	BH0202-40-625	5	Ø16x8Deep	Ø14,0	11	40	30
BH0200-40-606	BH0201-40-606	BH0202-40-606	6	Ø17x9Deep.	Ø15,0	11	40	30
BH0200-58-608	BH0201-58-608	BH0202-58-608	8	Ø22x11Deep	Ø19,5	16	58	46
BH0200-58-6000	BH0201-58-6000	BH0202-58-6000	10	Ø26x12Deep	Ø24,0	16	58	46
BH0200-58-6201	BH0201-58-6201	BH0202-58-6201	12	Ø32x14Deep	Ø28,0	16	58	46
BH0200-94-6202	BH0201-94-6202	BH0202-94-6202	15	Ø35x18Deep	Ø33,0	25	94	78
BH0200-94-6003	BH0201-94-6003	BH0202-94-6003	17	Ø35x17Deep	Ø33,0	25	94	78
BH0200-94-6004	BH0201-94-6004	BH0202-94-6004	20	Ø42x19Deep	Ø38,0	25	94	78
BH0200-94-6005	BH0201-94-6005	BH0202-94-6005	25	Ø47x19Deep	Ø43,0	25	94	78
BH0200-94-6006	BH0201-94-6006	BH0202-94-6006	30	Ø55x20Deep	Ø50,0	25	94	78

Dimensions in mm

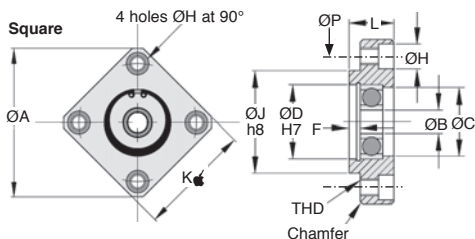
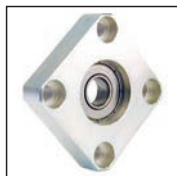

DISCOUNTS

Qty	1+	6+	20+	40+
Disc.	List	-15%	-20%	On request

Price each 1 to 5									
ØH	THD	K	Bearing	N	ØJ	F	Round	Double flat	Square
07,5x4,5Deep. (M4 Screw)	Ø4,20 (M5)	30	623ZZ	24	Ø22x3	3	51,57 €	58,31 €	61,09 €
07,5x4,5Deep. (M4 Screw)	Ø4,20 (M5)	30	634ZZ	24	Ø22x3	3	51,57 €	58,31 €	61,09 €
07,5x4,5Deep. (M4 Screw)	Ø4,20 (M5)	30	625ZZ	24	Ø22x3	3	51,57 €	58,31 €	61,09 €
07,5x4,5Deep. (M4 Screw)	Ø4,20 (M5)	30	606ZZ	24	Ø22x3	3	51,57 €	58,31 €	61,09 €
09,5x5,5Deep. (M5 Screw)	Ø5,20 (M6)	44	608ZZ	40	Ø36x4	4	70,16 €	72,36 €	101,82 €
09,5x5,5Deep. (M5 Screw)	Ø5,20 (M6)	44	6000ZZ	40	Ø36x4	4	70,16 €	72,36 €	101,82 €
015,0x8,5Deep. (M8 Screw)	Ø5,20 (M6)	44	6201ZZ	40	Ø36x4	4	70,16 €	72,36 €	101,82 €
015,0x8,5Deep. (M8 Screw)	Ø8,50 (M10)	77	6202ZZ	67	Ø66x6	7	101,77 €	114,85 €	163,01 €
015,0x8,5Deep. (M8 Screw)	Ø8,50 (M10)	77	6003ZZ	67	Ø66x6	7	101,77 €	114,85 €	163,01 €
015,0x8,5Deep. (M8 Screw)	Ø8,50 (M10)	77	6004ZZ	67	Ø66x6	7	101,74 €	114,85 €	163,01 €
015,0x8,5Deep. (M8 Screw)	Ø8,50 (M10)	77	6005ZZ	67	Ø66x6	7	101,77 €	114,85 €	163,01 €
015,0x8,5Deep. (M8 Screw)	Ø8,50 (M10)	77	6006ZZ	67	Ø66x6	7	101,77 €	114,85 €	163,01 €

Dimensions in mm

Our other products



FF15

Offset spur gear reducer, from 2.20 to 10 Nm



PLB

Cylindrical spacer, Brass



FF50

Offset spur gear reducer, from 111 to 425 Nm



HBM

Adjustment bushing for half-rail guide, Adjustment bushing



LF

Precision locknut, Precision locknut



EKN

Bellows coupling Gerwah®, from 0.5 to 12Nm



F7-SN

Multifunction display, Articulated support



PTA50ssEB

Articulated foot with sheet metal base Ø50, Articulated foot



CLB_M

Die cast zinc clamping lever - female, Zamak



PPRss

Pad eye on mounting plate round, Stainless

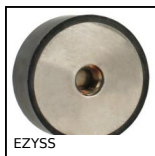

EZYSS

Stainless steel cylindrical stop,



NSKB

Drylin® Rail end cap, Rail end cap

Complementary products



BH02

Single housed bearing assembly, Bearing secured with circlips

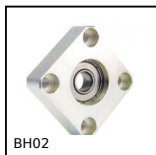

BH02

Single housed bearing assembly, Bearing secured with circlips