

Single housed bearing assembly

BH02 Bearing retained by with circlips

- Bearing mounted in housing with circlips
- Housing supplied with bearing
- ZZ bearing (with shielding)
- Materials:
Housing: zinc plated steel (60C40), natural finish
Bearing: steel
Circlips: steel

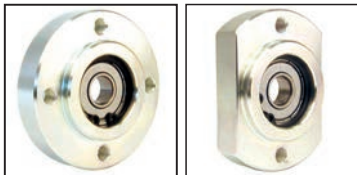

Options

- Flange with bearing glued in (BH01)

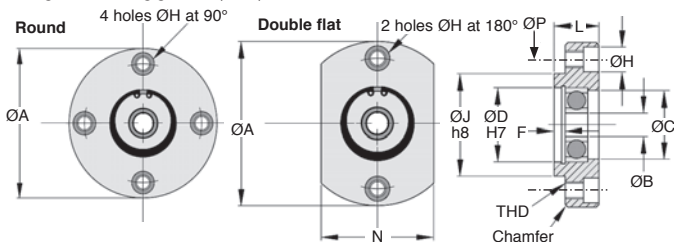

Part number			ØB	ØD	ØC	L	ØA	ØP
Round	Double flat	Square						
BH0200-40-623	BH0201-40-623	BH0202-40-623	3	Ø10x7Deep	Ø8,5	11	40	30
BH0200-40-634	BH0201-40-634	BH0202-40-634	4	Ø16x8Deep	Ø14,0	11	40	30
BH0200-40-625	BH0201-40-625	BH0202-40-625	5	Ø16x8Deep	Ø14,0	11	40	30
BH0200-40-606	BH0201-40-606	BH0202-40-606	6	Ø17x9Deep	Ø15,0	11	40	30
BH0200-58-608	BH0201-58-608	BH0202-58-608	8	Ø22x11Deep	Ø19,5	16	58	46
BH0200-58-6000	BH0201-58-6000	BH0202-58-6000	10	Ø26x12Deep	Ø24,0	16	58	46
BH0200-58-6201	BH0201-58-6201	BH0202-58-6201	12	Ø32x14Deep	Ø28,0	16	58	46
BH0200-94-6202	BH0201-94-6202	BH0202-94-6202	15	Ø35x18Deep	Ø33,0	25	94	78
BH0200-94-6003	BH0201-94-6003	BH0202-94-6003	17	Ø35x17Deep	Ø33,0	25	94	78
BH0200-94-6004	BH0201-94-6004	BH0202-94-6004	20	Ø42x19Deep	Ø38,0	25	94	78
BH0200-94-6005	BH0201-94-6005	BH0202-94-6005	25	Ø47x19Deep	Ø43,0	25	94	78
BH0200-94-6006	BH0201-94-6006	BH0202-94-6006	30	Ø55x20Deep	Ø50,0	25	94	78

Dimensions in mm

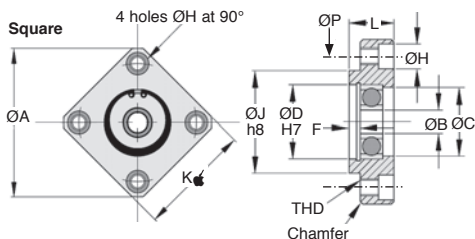

DISCOUNTS

Qty	1+	6+	20+	40+
Disc.	List	-15%	-20%	On request

Price each 1 to 5									
ØH	THD	K	Bearing	N	ØJ	F	Round	Double flat	Square
Ø7,5x4,5Deep. (M4 Screw)	Ø4,20 (M5)	30	623ZZ	24	Ø22x3	3	51,57 €	58,31 €	61,09 €
Ø7,5x4,5Deep. (M4 Screw)	Ø4,20 (M5)	30	634ZZ	24	Ø22x3	3	51,57 €	58,31 €	61,09 €
Ø7,5x4,5Deep. (M4 Screw)	Ø4,20 (M5)	30	625ZZ	24	Ø22x3	3	51,57 €	58,31 €	61,09 €
Ø7,5x4,5Deep. (M4 Screw)	Ø4,20 (M5)	30	606ZZ	24	Ø22x3	3	51,57 €	58,31 €	61,09 €
Ø9,5x5,5Deep. (M5 Screw)	Ø5,20 (M6)	44	608ZZ	40	Ø36x4	4	70,16 €	72,36 €	101,82 €
Ø9,5x5,5Deep. (M5 Screw)	Ø5,20 (M6)	44	6000ZZ	40	Ø36x4	4	70,16 €	72,36 €	101,82 €
Ø15,0x8,5Deep. (M8 Screw)	Ø5,20 (M6)	44	6201ZZ	40	Ø36x4	4	70,16 €	72,36 €	101,82 €
Ø15,0x8,5Deep. (M8 Screw)	Ø8,50 (M10)	77	6202ZZ	67	Ø66x6	7	101,77 €	114,85 €	163,01 €
Ø15,0x8,5Deep. (M8 Screw)	Ø8,50 (M10)	77	6003ZZ	67	Ø66x6	7	101,77 €	114,85 €	163,01 €
Ø15,0x8,5Deep. (M8 Screw)	Ø8,50 (M10)	77	6004ZZ	67	Ø66x6	7	101,74 €	114,85 €	163,01 €
Ø15,0x8,5Deep. (M8 Screw)	Ø8,50 (M10)	77	6005ZZ	67	Ø66x6	7	101,77 €	114,85 €	163,01 €
Ø15,0x8,5Deep. (M8 Screw)	Ø8,50 (M10)	77	6006ZZ	67	Ø66x6	7	101,77 €	114,85 €	163,01 €

Dimensions in mm

Our other products



DOG319

Motor-gearbox 12V and 24V DC, from 4 to 9 Nm



TK_UUOP

Topball self-aligning linear bearing, Topball self-aligning



SSB

Stainless steel bevel gear, 1:1



CDP

Flanged drill bushing, Steel



PSG35

Spur gear - precision range, Stainless steel 303



CHAR7520

Spring hinge, screwed



PGR

Folding revolving handle for handwheel, Folding



BPM_LOK

Long-Lok slotted spring plunger with ball tip, LONG-LOK - Steel



SRG

Adjustable latch clamp with strike plate, Stroke from



MFB_MHB

Moulded plastic bevel gear (nylon), 1.5:1



H4

Crossed helical gear crossed axis at 90°, Steel 20NCD2



BOX-INS-W

Box set of self tapping inserts, Boxed set - For wood

Complementary products



BH02

Single housed bearing assembly, Bearing secured with circlips

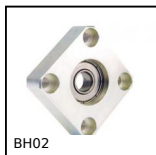

BH02

Single housed bearing assembly, Bearing secured with circlips