

## Couplings for servo-motors

Torque: **0.06 to 44Nm**

### - 3 part assembly

- Max. speed: 3000 rpm
- Working temp: -20°C to +60°C
- Materials:
  - BG6-BG13 Hubs: brass
  - CZ121
  - BG19-57 Hubs: Alocrom coated aluminium 6082
  - Disk: black acetel

Service factor	
Usage	Factor
Momentary	1
1hr/day	2
3h/day	4
6h/day	6
12h/day	8

**Torque to be transmitted X Service Factor must be less than Peak Torque**

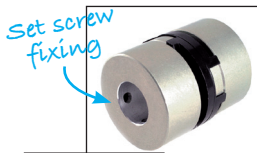

### Info

- Delivered not assembled

	Misalignment at 3000 rpm			Torque Peak (Nm)	Static break (Nm)	Moment of inertia (kgm <sup>2</sup> x 10 <sup>-6</sup> )	Torsional stiffness (Nm/Rad)
	Radial (± mm)	Axial (± mm)	Angular (± °)				
BG6	0,10	0,05	0,5°	<b>0,06</b>	0,7	6	10
BG9	0,10	0,05	0,5°	<b>0,21</b>	2,0	18	30
BG13	0,10	0,05	0,5°	<b>0,5</b>	4,0	26	65
BG19	0,20	0,10	0,5°	<b>1,7</b>	10,8	67	115
BG25	0,20	0,10	0,5°	<b>4,0</b>	13,0	252	205
BG33	0,20	0,15	0,5°	<b>9,0</b>	53,0	1 074	615
BG41	0,25	0,15	0,5°	<b>17,0</b>	57,0	3 327	1 200
BG50	0,25	0,20	0,5°	<b>30,0</b>	95,0	7 550	1 375
BG57	0,25	0,20	0,5°	<b>44,0</b>	150,0	12 410	2 610

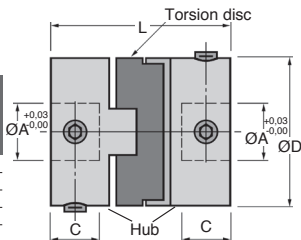

### DISCOUNTS

Qty	1+	5+	10+
Disc.	List	-6%	On request

Part number	Standard bores (mm)		Optional bores (mm)		ØD	L	C	Vis	Weight (g)	Standard bores	Price each 1 to 4 Standard bores
BG6	2		3, 3.18		6,40	12,70	3,80	M3	2,5	✓	On request
BG9	3, 4, 5		-		9,50	12,70	3,80	M3	4	✓	On request
BG13	3		4, 5, 6, 6.35		12,70	15,90	4,30	M3	11	✓	On request
BG19	4, 6, 8		5, 6.35		19,10	22,00	6,30	M3	12	✓	22,88 €
BG25	6, 8, 10		6.35, 9.52, 12		25,40	28,40	8,60	M4	31	✓	On request
BG33	8, 12		9.52, 10, 14, 15, 16		33,30	42,00	13,00	M4	86	✓	On request
BG41	9.52, 10		12, 14, 15, 16, 18, 19, 20		41,30	50,80	16,70	M5	148	✓	On request
BG50	10, 20		12, 14, 15, 16, 18, 19, 24, 25		50,00	59,60	20,60	M8	208	✓	On request
BG57	12, 20		14, 15, 16, 18, 19, 24, 25, 30		57,10	78,00	28,40	M8	361	✓	On request

\*Depending on availability - Dimensions in mm

## Our other products



Brush strip per meter horsehair fibres Ø0.2, Black horsehair



Steel leadscrew, Medium carbon steel - 2 threads



Spring loaded toggle latch, With padlock-holder



Utilitak® V rail, V rail



Worm - precision range, Steel



Articulated fixable foot with pressed base Ø100, Ø 100



Pull handle - Multi-sector, Tapped recessed insert



Pull handle, Up to 250 °C



Socket head button screw, Stainless steel A2



Die spring ISO10243, Extra-heavy



HTD type tooth bar stock, HTD5



Small 6 lobe female handle, Technopolymer - Stainless steel

## Complementary products



Oldham coupling, Clamp