

Pin for magnetic bush

BDM

Fast and light magnetic locking

- Pin for magnetic bush

- Fastening element used to hold panels or thin plates.
The pin is held in the bush housing by a magnet.
- Materials:
Natural finish steel

Info

- The pin is attracted to the magnetic bush
BDM6-7/DLL.
- Mounting option with nut (not included)
or by screwing directly into the workpiece.

Accessory

- Mounting pin **BDM6-7/DLL**

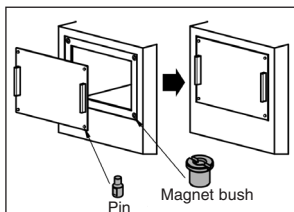

Typical application:

Quick assembly or removal of valves

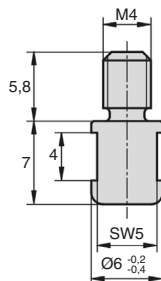
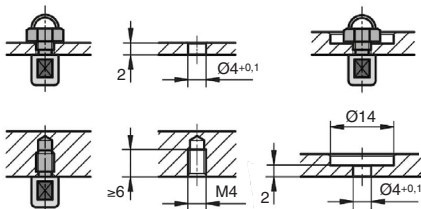

Recommended mounting
tolerances:

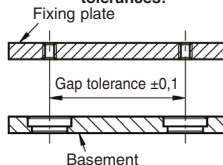

DISCOUNTS

Qty	1+	4+	8+
Disc. Price	-5%	-5%	On request

Part N°	Shear force (kN)	Price per unit 1 to 3
BDM6-7	0.9	3,14 €

*Depending on availability - Dimensions in mm

Pin for magnetic bush

Fast and light magnetic locking **BDMDLL**

- **Magnetic bush**
- The pin **BDM6-7** is held in the bush housing by a magnet which holds it with the specified clamping force.
- Materials:
Body in stainless steel natural finish
Neodymium magnet
Aimant
- Working temperature range: max 80°C

Assembly

- Form A: min. plate thickness 6 mm.
- Form B: max. plate thickness 10 mm.
- Form C: plate thickness > 10 mm.
- Form D: blind hole.

Info

- Repeatability +/-0.25mm

Accessory

- Pin for magnetic bush **BDM6-7**

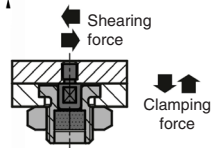
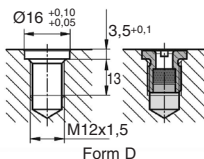
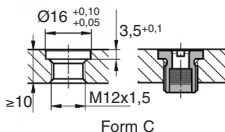
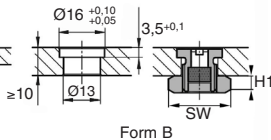
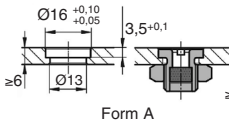
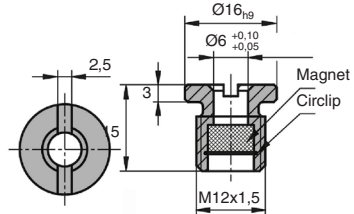

DISCOUNTS

Qty	1+	4+	8+
Disc. Price		-5%	On request

Part N°	Clamping force (N)	Shearing force (kN)	H1	SW	Price per unit 1 to 3
BDM6-7/DLL	7	0.8	-	-	12,60 €
DLL-M12-EC/SS	Nut for BDM6-7/DLL				0,57 €
DLL-M16-TOOL	Assembly tools for BDM6-7/DLL				20,81 €

*Depending on availability - Dimensions in mm

Our other products



LWH
High rigidity linear slide, Rail - from 9320 N to 71300 N



SER69K
Quarter turn latch for the food industry, Stainless steel



JCSss
Single stainless steel universal joint, Low duty



CHAEss
Decorative hinge, Stainless steel



V3RA
3-spoked handwheel without handle, Polyamide



DOMI80
Accessories, Turntable



ACLERP
Roller block for aluminium profile, With guide rail



YG1
HEAVY DUTY spur gear, Steel 35NCD6



SFE
Female rod ends, Stainless steel / PTFE



EKN
Bellows coupling Gerwah®, from 0.5 to 100 mm



ZBconique
Machined plastic bevel gear, 1:1



STU
Stroke rotary bushing, Steel

Complementary products



BDM
Pin for magnetic bush, Fast and light magnetic locking