

Mushroom knob with male thread with low head

BCTBUSS

Hygienic Usit®

- **Mushroom knob with a female thread and low head for use with Hygienic Usit® sealing washers**

- The low head makes this mushroom knob ideal for manual lateral movements.

- Fully polished surface with a roughness much lower than Ra0.8µm.

- Material:

Stainless steel 1.4404 (316L)

Mirror polished finish

Advantages

- Regardless of the mounting position of the mushroom knob, dirt and residue from product or cleaning material will not adhere. This guarantees easy cleaning.

- USIT® Hygienic sealing washers are used to seal the screwed connection.

- The base of the mushroom knob is specially designed to ensure an almost cavity free seal thus meeting hygiene requirements.

Accessory

- RDE sealing washers (see pages 37 - 39)

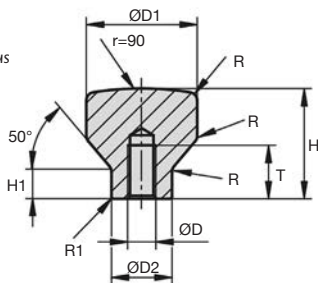

DISCOUNTS

Qty	1+	6+	10+	25+
Disc.	Net	-5%	-10%	On request

Part N°	ØD	ØD1	ØD2	H	H1	T	R	R1	Price each
									1 to 4
BCTB-4/HUSS	M4	20	10,8	19	3,5	10	3	0,45	10,84 €
BCTB-5/HUSS	M5	21	11,8	21	5,5	12	3	0,50	11,74 €
BCTB-6/HUSS	M6	25	14,2	25	7,0	12	3	0,55	13,07 €
BCTB-8/HUSS	M8	33	18,0	33	9,0	16	4	0,60	22,01 €
BCTB-10/HUSS	M10	40	22,3	40	11,5	20	4	0,75	23,47 €

All dimensions in mm

Our other products



Hinges and joints,
Hinge



Gas spring, Steel



Parallel axis helical
gear, Machined plastic
(delrin)



Worm - precision
range, Delrin



Tools Hygienic Usit®
and Hygienic
Design®, Socket for
mounting Hygienic



Spring plunger with
pressure pin, steel
body and pin



Dowel pin, Boxed set -
taper DIN1B

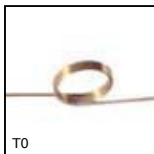

Torsion spring,
Stainless steel



Tensioner pulley,
Shaft



Dowel pin, Boxed set -
hitch



Connecting/joining,
Cross connector

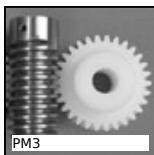

Wheel, Machined
plastic (delrin)

Complementary products



Sealing washer
Hygienic Usit®,
Stainless steel - Black
EPDM

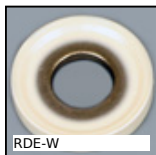

Sealing washer
Hygienic Usit®,
Stainless steel - White
EPDM



Sealing washer
Hygienic Usit®,
Stainless steel - Blue
EPDM



Mushroom headed
button Hygienic
Usit®, With female
thread and high head