

Clamping collar



BAP

Ø10 to Ø20

- 2 part clamping collar

- Materials:

Body: reinforced polyamide

Screws: stainless steel 304

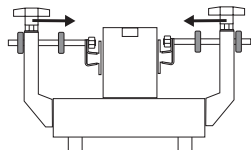
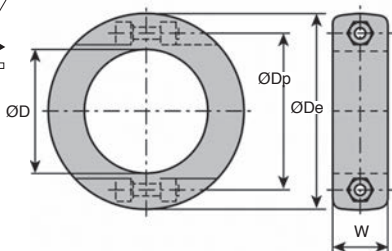
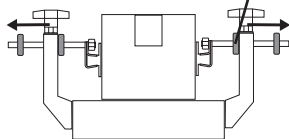
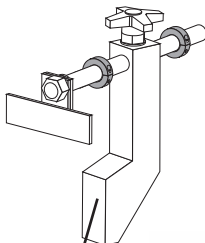
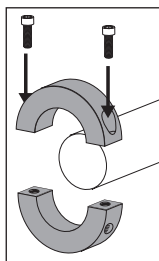

DISCOUNTS

Qty	1+	40+	100+	200+	300+
Disc.	List	-5%	-10%	-15%	On request

Part number	ØD	ØDe	ØDp	W	Weight (kg)	Stock*	Price each 1 to 39
BAP-10	10	30	20	12	0,01	✓	3,15 €
BAP-12	12	30	20	12	0,01	✓	3,15 €
BAP-14	14	30	20	12	0,01	✓	3,15 €
BAP-15	15	39	27	14	0,02	✓	3,15 €
BAP-16	16	39	27	14	0,02	✓	3,15 €
BAP-18	18	39	27	14	0,02	✓	3,15 €
BAP-20	20	40	29	14	0,02	✓	3,15 €

*Depending on availability - Dimensions in mm

Our other products



PT820

Drive sprocket for slat top chain, Ranges 820 and 815



M1

Worm and wheel set, Non hardened steel

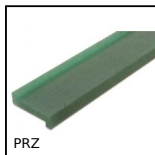

PRZ

Wear strip for slat top chain, Z profile to be filled



BTE

Universal tension arm, For standard applications

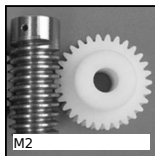

M2

Worm and wheel set, Machined plastic (delrin)



GP

Spring loaded toggle latch, With padlock-holder



KH

Linear bearing, Light



AHX

Hexagonal shaft, Hexagonal shaft



T2

T type timing belt, T2.5 Steel cored

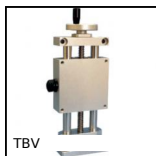

TBV

Manual lifting tables, For vertical strokes -



PGMT

Pull handle, Stainless steel



PW_PWG1

Wheel - precision range, Bronze

Complementary products



BAP25

Plastic clamping collar, Ø25 - Ø40



BAG

Steel Clamping collar, Steel



BAGSS

Stainless steel Clamping collar, Stainless steel



PR820

Idler sprocket for slat top chain, Rangs 820 and 815