

# Clamping collar



## BAP

## Ø10 to Ø20

- 2 part clamping collar

- Materials:

Body: reinforced polyamide

Screws: stainless steel 304

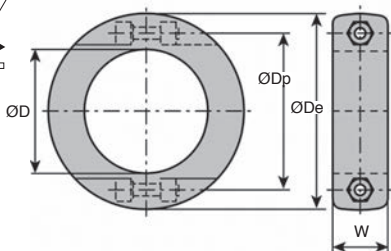
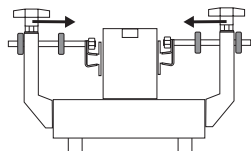
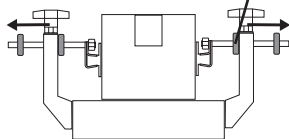
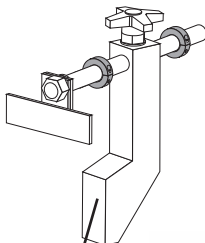
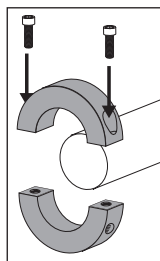

### DISCOUNTS

Qty	1+	40+	100+	200+	300+
Disc.	List	-5%	-10%	-15%	On request

Part number	ØD	ØDe	ØDp	W	Weight (kg)	Stock*	Price each 1 to 39
BAP-10	10	30	20	12	0,01	✓	3,15 €
BAP-12	12	30	20	12	0,01	✓	3,15 €
BAP-14	14	30	20	12	0,01	✓	3,15 €
BAP-15	15	39	27	14	0,02	✓	3,15 €
BAP-16	16	39	27	14	0,02	✓	3,15 €
BAP-18	18	39	27	14	0,02	✓	3,15 €
BAP-20	20	40	29	14	0,02	✓	3,15 €

\*Depending on availability - Dimensions in mm

## Our other products



RFKfp  
Stainless steel  
gearbox - accessories,  
Mounting bracket



PRF\_GAL  
Roller for aluminium  
profile, Fixing kit for  
roller concentric



SLB  
Indexing plunger,  
steel class 5.8



GP75  
Spring loaded toggle  
latch, Standard  
(GP75)



T5courroie  
T type timing belt, T5  
Steel cored  
polyurethane



SRG  
Adjustable latch  
clamp with strike  
plate, Stroke from  
77,3mm to 83mm



SER  
Magnetic doorstop for  
aluminium profile,  
Magnetic doorstop



VHTM  
Hexagonal headed  
screw Hygienic  
Design®, Stainless  
steel



RDS  
Safety washer  
Hygienic Usit®,  
Stainless steel



AT10-BAR  
AT type tooth bar  
stock, AT10



P55  
Worm and wheel gear  
reducer, up to 57 Nm



HBM  
Adjustment bushing  
for half-rail guide,  
Adjustment bushing

## Complementary products



BAP25  
Plastic clamping  
collar, Ø25 - Ø40



BAG  
Steel Clamping collar,  
Steel



BAGSS  
Stainless steel  
Clamping collar,  
Stainless steel



PR820  
Idler sprocket for slat  
top chain, Rangs  
820 and 815