

# Ball lock pins lockable



## BABv

## With simple grip

- Lockable version prevents **unintentional loosening of the connection**
- The balls can only be unlocked using a key
- Materials :
  - Handle: red thermoplastic (RAL3020)
  - Shaft: 303 stainless steel
  - Components: stainless steel
  - Lock: Die cast zinc
  - Key: Zinc-plated steel
- For H11 bore

### Advantages

- Press to unlock
- Quick and easy to assemble, block, adjust, change and stop
- Simply and quickly released when performing repetitive operations
- Corrosion resistant
- Resists high loads
- Ergonomic handle
- Can be fitted with **CDR** retaining cable (**tome 1 p.35**)

### Infos

- Shear strength to DIN 50141
- The push-button lock has identical locking. All cylinders can be opened with the same key. Lockable locking pins are supplied with two keys



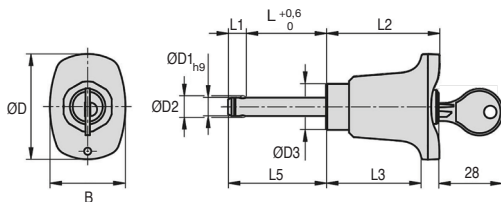

## DISCOUNTS

Qty	1+	6+	10+
Disc. List	-5%	-5%	On request

Part Number	B	ØD	ØD1	ØD2	ØD3	L	L1	L2	L3	L5	Double shear resistance kN min	Price each 1 to 5
BAB8-20/V/R	33	45,9	8	9,5	20	20	7,8	49,5	41,3	27,8	38	43,94 €
BAB8-25/V/R	33	45,9	8	9,5	20	25	7,8	49,5	41,3	32,8	38	43,94 €
BAB8-30/V/R	33	45,9	8	9,5	20	30	7,8	49,5	41,3	37,8	38	47,10 €
BAB8-35/V/R	33	45,9	8	9,5	20	35	7,8	49,5	41,3	42,8	38	47,10 €
BAB8-40/V/R	33	45,9	8	9,5	20	40	7,8	49,5	41,3	47,8	38	47,10 €
BAB8-45/V/R	33	45,9	8	9,5	20	45	7,8	49,5	41,3	52,8	38	47,10 €
BAB8-50/V/R	33	45,9	8	9,5	20	50	7,8	49,5	41,3	57,8	38	47,10 €
BAB10-20/V/R	33	45,9	10	12,0	20	20	8,9	49,5	41,3	28,9	60	61,41 €
BAB10-25/V/R	33	45,9	10	12,0	20	25	8,9	49,5	41,3	33,9	60	61,41 €
BAB10-30/V/R	33	45,9	10	12,0	20	30	8,9	49,5	41,3	38,9	60	64,08 €
BAB10-35/V/R	33	45,9	10	12,0	20	35	8,9	49,5	41,3	43,9	60	64,08 €
BAB10-40/V/R	33	45,9	10	12,0	20	40	8,9	49,5	41,3	48,9	60	64,08 €
BAB10-45/V/R	33	45,9	10	12,0	20	45	8,9	49,5	41,3	53,9	60	64,08 €
BAB10-50/V/R	33	45,9	10	12,0	20	50	8,9	49,5	41,3	58,9	60	64,08 €
BAB10-60/V/R	33	45,9	10	12,0	20	60	8,9	49,5	41,3	68,9	60	67,40 €
BAB12-25/V/R	33	45,9	12	14,5	20	25	9,9	49,5	41,3	34,9	86	55,18 €
BAB12-30/V/R	33	45,9	12	14,5	20	30	9,9	49,5	41,3	39,9	86	58,16 €
BAB12-35/V/R	33	45,9	12	14,5	20	35	9,9	49,5	41,3	44,9	86	58,16 €
BAB12-40/V/R	33	45,9	12	14,5	20	40	9,9	49,5	41,3	49,9	86	58,16 €
BAB12-45/V/R	33	45,9	12	14,5	20	45	9,9	49,5	41,3	54,9	86	58,16 €
BAB12-50/V/R	33	45,9	12	14,5	20	50	9,9	49,5	41,3	59,9	86	58,16 €
BAB12-60/V/R	33	45,9	12	14,5	20	60	9,9	49,5	41,3	69,9	86	61,14 €
BAB12-70/V/R	33	45,9	12	14,5	20	70	9,9	49,5	41,3	79,9	86	61,14 €
BAB12-80/V/R	33	45,9	12	14,5	20	80	9,9	49,5	41,3	89,9	86	63,78 €
BAB16-30/V/R	33	45,9	16	19	20	30	13,1	49,5	41,3	43,1	153	81,76 €
BAB16-35/V/R	33	45,9	16	19	20	35	13,1	49,5	41,3	48,1	153	83,07 €
BAB16-40/V/R	33	45,9	16	19	20	40	13,1	49,5	41,3	53,1	153	83,07 €
BAB16-45/V/R	33	45,9	16	19	20	45	13,1	49,5	41,3	58,1	153	83,07 €
BAB16-50/V/R	33	45,9	16	19	20	50	13,1	49,5	41,3	63,1	153	83,07 €
BAB16-60/V/R	33	45,9	16	19	20	60	13,1	49,5	41,3	73,1	153	88,27 €
BAB16-70/V/R	33	45,9	16	19	20	70	13,1	49,5	41,3	83,1	153	88,27 €
BAB16-80/V/R	33	45,9	16	19	20	80	13,1	49,5	41,3	93,1	153	93,43 €

Dimensions in mm

## Our other products



LF

Precision locknut,  
Precision locknut



CHAGC-AL

Screw-in garnet  
hinge, Screw-on



NAST

Cam follower without  
axial guide, With  
interior ring



MCLred

Reducing sleeve  
female/female,  
Cylindrical - stainless  
steel



RHTplss

High Temperature  
Castor, up to 200kg



VDSQCB

Sliding lock  
adjustment system,  
Blocking wedge



BOX-INS-W

Box set of self tapping  
inserts, Boxed set -  
For wood



ACA

Steel splined shaft,  
Steel



PDM\_PDV

Detectable plastic  
palm grip, by metal  
detectors



LPCM

Lever with cylindrical  
handle, Black  
Duroplast, steel lever



RFV63

Stainless steel worm  
and wheel gearbox,  
up to 152 Nm



GEC

Rubber latch clamp  
with strike plate,  
Lockable

## Complementary products



BABTV

Ball lock pins lockable  
, Stainless steel



BABreceptacle

Ball pin socket, Socket



BABFCFO

Ball pin socket,  
Mounting collar with a  
round flange



BABFCFO

Ball pin socket,  
Mounting collar with a  
oval flange