

Clamping pin, 303 stainless steel



BABS303

Compact

- Self locking
- Materials:
 - Shaft: Stainless steel 303
 - Spring: Stainless steel
- Working temp: max 150°C

Advantages

- Press to unlock
- Quick and easy to assemble, block, adjust change and stop
- Simply and quickly to released when performing repetitive operations
- Corrosion resistant
- Handle designed to avoid accidental release
- Compact size with ergonomically designed handle



Press to unlock

Lower cost material

Options

- BABS Ball pin manufactured from hardened stainless steel (630) offers increased double shear strength

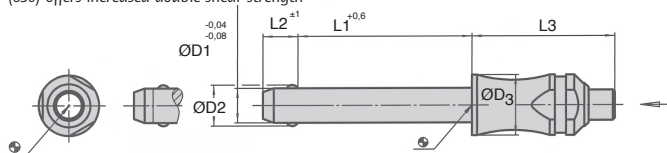

DISCOUNTS

Qty	1+	6+	10+
Disc. List		-5%	On request

Part number	Ød1	L1	Ød2	Ød3	L2	L3	For bore H11	Double shear strength (kN)	Weight (g)	Price each 1 to 5
BAB5-10/S303	5	10	5,5	10	6,0	26,2	5	14	10	18,29 €
BAB5-15/S303	5	15	5,5	10	6,0	26,2	5	14	11	18,31 €
BAB5-20/S303	5	20	5,5	10	6,0	26,2	5	14	12	18,31 €
BAB5-25/S303	5	25	5,5	10	6,0	26,2	5	14	13	18,31 €
BAB5-30/S303	5	30	5,5	10	6,0	26,2	5	14	13	19,47 €
BAB6-10/S303	6	10	7,0	10	7,0	26,2	6	21	11	18,41 €
BAB6-15/S303	6	15	7,0	10	7,0	26,2	6	21	12	18,41 €
BAB6-20/S303	6	20	7,0	10	7,0	26,2	6	21	13	18,41 €
BAB6-25/S303	6	25	7,0	10	7,0	26,2	6	21	14	18,41 €
BAB6-30/S303	6	30	7,0	10	7,0	26,2	6	21	15	20,60 €
BAB6-35/S303	6	35	7,0	10	7,0	26,2	6	21	16	20,60 €
BAB6-40/S303	6	40	7,0	10	7,0	26,2	6	21	17	20,60 €
BAB6-45/S303	6	45	7,0	10	7,0	26,2	6	21	18	20,60 €
BAB6-50/S303	6	50	7,0	10	7,0	26,2	6	21	19	20,60 €

Dimensions in mm

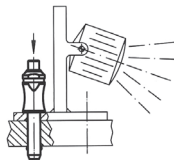
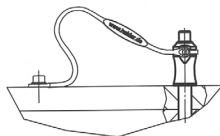
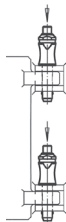

DISCOUNTS

Qty	1+	6+	10+
Disc.	List	-5%	On request

Part number	Ød1	L1	Ød2	Ød3	L2	L3	For bore H11	Double shear strength (kN)	Weight (g)	Price each 1 to 5
BAB8-20/S303	8	20	9,6	14	8,2	33,1	8	38	33	19,86 €
BAB8-25/S303	8	25	9,6	14	8,2	33,1	8	38	34	19,86 €
BAB8-30/S303	8	30	9,6	14	8,2	33,1	8	38	36	22,33 €
BAB8-35/S303	8	35	9,6	14	8,2	33,1	8	38	38	22,33 €
BAB8-40/S303	8	40	9,6	14	8,2	33,1	8	38	40	22,33 €
BAB8-45/S303	8	45	9,6	14	8,2	33,1	8	38	42	22,33 €
BAB8-50/S303	8	50	9,6	14	8,2	33,1	8	38	44	22,33 €
BAB10-20/S303	10	20	12,0	14	9,6	33,1	10	60	39	30,32 €
BAB10-25/S303	10	25	12,0	14	9,6	33,1	10	60	42	30,32 €
BAB10-30/S303	10	30	12,0	14	9,6	33,1	10	60	45	32,00 €
BAB10-35/S303	10	35	12,0	14	9,6	33,1	10	60	48	32,00 €
BAB10-40/S303	10	40	12,0	14	9,6	33,1	10	60	51	32,00 €
BAB10-45/S303	10	45	12,0	14	9,6	33,1	10	60	54	32,00 €
BAB10-50/S303	10	50	12,0	14	9,6	33,1	10	60	57	32,00 €
BAB10-60/S303	10	60	12,0	14	9,6	33,1	10	60	63	33,57 €
BAB12-25/S303	12	25	14,5	20	10,6	39,5	12	87	84	30,95 €
BAB12-30/S303	12	30	14,5	20	10,6	39,5	12	87	88	32,43 €
BAB12-35/S303	12	35	14,5	20	10,6	39,5	12	87	92	32,43 €
BAB12-40/S303	12	40	14,5	20	10,6	39,5	12	87	96	32,43 €
BAB12-45/S303	12	45	14,5	20	10,6	39,5	12	87	101	32,43 €
BAB12-50/S303	12	50	14,5	20	10,6	39,5	12	87	105	32,43 €
BAB12-60/S303	12	60	14,5	20	10,6	39,5	12	87	113	34,01 €
BAB12-70/S303	12	70	14,5	20	10,6	39,5	12	87	122	34,01 €
BAB12-80/S303	12	80	14,5	20	10,6	39,5	12	87	130	35,37 €
BAB16-30/S303	16	30	19,0	20	14,0	39,5	16	155	120	55,30 €
BAB16-35/S303	16	35	19,0	20	14,0	39,5	16	155	127	55,30 €
BAB16-40/S303	16	40	19,0	20	14,0	39,5	16	155	135	55,30 €
BAB16-45/S303	16	45	19,0	20	14,0	39,5	16	155	143	55,30 €
BAB16-50/S303	16	50	19,0	20	14,0	39,5	16	155	150	55,30 €
BAB16-60/S303	16	60	19,0	20	14,0	39,5	16	155	166	59,60 €
BAB16-70/S303	16	70	19,0	20	14,0	39,5	16	155	181	59,60 €
BAB16-80/S303	16	80	19,0	20	14,0	39,5	16	155	196	63,30 €
BAB20-60/S303	20	60	25,0	28	20,5	50,1	20	244	322	111,99 €
BAB20-80/S303	20	80	25,0	28	20,5	50,1	20	244	370	116,50 €
BAB20-100/S303	20	100	25,0	28	20,5	50,1	20	244	414	122,20 €
BAB20-120/S303	20	120	25,0	28	20,5	50,1	20	244	466	126,85 €

Dimensions in mm

Our other products



ERC

Quick fitting cable terminal, Eye version

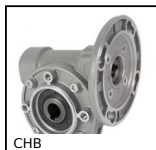

CHB

Worm and wheel gear reducer, up to 41 Nm



HW_HT

Half-rail guide, Wheel



CHA_GC_955

Stainless steel garnet hinge, To be welded



M2

Worm and wheel set, Unhardened steel



WING

Manually tightened wing nut, Stainless steel DIN 314/315



PSG08

Spur gear - precision range, Case hardened steel 20NCD2



RDE-W

Sealing washer Hygienic Usit®, Stainless steel - White EPDM



LC

Friction clutch, 30 to 240 Nm

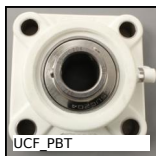

UCF_PBT

Stainless steel/Polymer flanged bearing, Polymer and

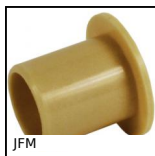

JFM

Flanged polymer bush, Universal polymer



MRASSeco

Low cost stainless steel quick link, Stainless steel

Complementary products



BABS

630 Stainless steel compact ball pin, Hardened stainless steel

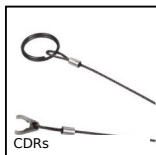

CDRs

Retaining cable for ball pin, Retaining cable