

Clamping pin, 303 stainless steel



BABS303

Compact

- Self locking
- Materials:
 - Shaft: Stainless steel 303
 - Spring: Stainless steel
- Working temp: max 150°C

Advantages

- Press to unlock
- Quick and easy to assemble, block, adjust change and stop
- Simply and quickly to released when performing repetitive operations
- Corrosion resistant
- Handle designed to avoid accidental release
- Compact size with ergonomically designed handle



Press to unlock

Lower cost material

Options

- BABS Ball pin manufactured from hardened stainless steel (630) offers increased double shear strength

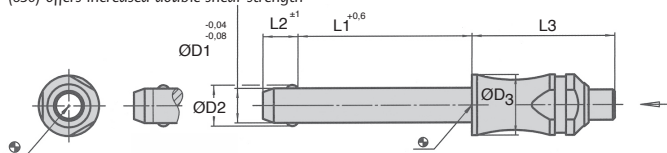

DISCOUNTS

| | | | |
|------------|-----|----|------------|
| Qty | 1+ | 6+ | 10+ |
| Disc. List | -5% | | On request |

| Part number | Ød1 | L1 | Ød2 | Ød3 | L2 | L3 | For bore H11 | Double shear strength (kN) | Weight (g) | Price each 1 to 5 |
|--------------|-----|----|-----|-----|-----|------|--------------|----------------------------|------------|-------------------|
| BAB5-10/S303 | 5 | 10 | 5,5 | 10 | 6,0 | 26,2 | 5 | 14 | 10 | 18,29 € |
| BAB5-15/S303 | 5 | 15 | 5,5 | 10 | 6,0 | 26,2 | 5 | 14 | 11 | 18,31 € |
| BAB5-20/S303 | 5 | 20 | 5,5 | 10 | 6,0 | 26,2 | 5 | 14 | 12 | 18,31 € |
| BAB5-25/S303 | 5 | 25 | 5,5 | 10 | 6,0 | 26,2 | 5 | 14 | 13 | 18,31 € |
| BAB5-30/S303 | 5 | 30 | 5,5 | 10 | 6,0 | 26,2 | 5 | 14 | 13 | 19,47 € |
| BAB6-10/S303 | 6 | 10 | 7,0 | 10 | 7,0 | 26,2 | 6 | 21 | 11 | 18,41 € |
| BAB6-15/S303 | 6 | 15 | 7,0 | 10 | 7,0 | 26,2 | 6 | 21 | 12 | 18,41 € |
| BAB6-20/S303 | 6 | 20 | 7,0 | 10 | 7,0 | 26,2 | 6 | 21 | 13 | 18,41 € |
| BAB6-25/S303 | 6 | 25 | 7,0 | 10 | 7,0 | 26,2 | 6 | 21 | 14 | 18,41 € |
| BAB6-30/S303 | 6 | 30 | 7,0 | 10 | 7,0 | 26,2 | 6 | 21 | 15 | 20,60 € |
| BAB6-35/S303 | 6 | 35 | 7,0 | 10 | 7,0 | 26,2 | 6 | 21 | 16 | 20,60 € |
| BAB6-40/S303 | 6 | 40 | 7,0 | 10 | 7,0 | 26,2 | 6 | 21 | 17 | 20,60 € |
| BAB6-45/S303 | 6 | 45 | 7,0 | 10 | 7,0 | 26,2 | 6 | 21 | 18 | 20,60 € |
| BAB6-50/S303 | 6 | 50 | 7,0 | 10 | 7,0 | 26,2 | 6 | 21 | 19 | 20,60 € |

Dimensions in mm

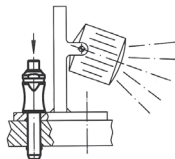
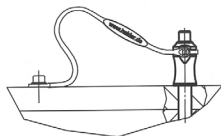
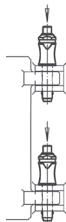

DISCOUNTS

| | | | |
|-------|------|-----|------------|
| Qty | 1+ | 6+ | 10+ |
| Disc. | List | -5% | On request |

| Part number | Ød1 | L1 | Ød2 | Ød3 | L2 | L3 | For bore H11 | Double shear strength (kN) | Weight (g) | Price each 1 to 5 |
|----------------|-----|-----|------|-----|------|------|--------------|----------------------------|------------|-------------------|
| BAB8-20/S303 | 8 | 20 | 9,6 | 14 | 8,2 | 33,1 | 8 | 38 | 33 | 19,86 € |
| BAB8-25/S303 | 8 | 25 | 9,6 | 14 | 8,2 | 33,1 | 8 | 38 | 34 | 19,86 € |
| BAB8-30/S303 | 8 | 30 | 9,6 | 14 | 8,2 | 33,1 | 8 | 38 | 36 | 22,33 € |
| BAB8-35/S303 | 8 | 35 | 9,6 | 14 | 8,2 | 33,1 | 8 | 38 | 38 | 22,33 € |
| BAB8-40/S303 | 8 | 40 | 9,6 | 14 | 8,2 | 33,1 | 8 | 38 | 40 | 22,33 € |
| BAB8-45/S303 | 8 | 45 | 9,6 | 14 | 8,2 | 33,1 | 8 | 38 | 42 | 22,33 € |
| BAB8-50/S303 | 8 | 50 | 9,6 | 14 | 8,2 | 33,1 | 8 | 38 | 44 | 22,33 € |
| BAB10-20/S303 | 10 | 20 | 12,0 | 14 | 9,6 | 33,1 | 10 | 60 | 39 | 30,32 € |
| BAB10-25/S303 | 10 | 25 | 12,0 | 14 | 9,6 | 33,1 | 10 | 60 | 42 | 30,32 € |
| BAB10-30/S303 | 10 | 30 | 12,0 | 14 | 9,6 | 33,1 | 10 | 60 | 45 | 32,00 € |
| BAB10-35/S303 | 10 | 35 | 12,0 | 14 | 9,6 | 33,1 | 10 | 60 | 48 | 32,00 € |
| BAB10-40/S303 | 10 | 40 | 12,0 | 14 | 9,6 | 33,1 | 10 | 60 | 51 | 32,00 € |
| BAB10-45/S303 | 10 | 45 | 12,0 | 14 | 9,6 | 33,1 | 10 | 60 | 54 | 32,00 € |
| BAB10-50/S303 | 10 | 50 | 12,0 | 14 | 9,6 | 33,1 | 10 | 60 | 57 | 32,00 € |
| BAB10-60/S303 | 10 | 60 | 12,0 | 14 | 9,6 | 33,1 | 10 | 60 | 63 | 33,57 € |
| BAB12-25/S303 | 12 | 25 | 14,5 | 20 | 10,6 | 39,5 | 12 | 87 | 84 | 30,95 € |
| BAB12-30/S303 | 12 | 30 | 14,5 | 20 | 10,6 | 39,5 | 12 | 87 | 88 | 32,43 € |
| BAB12-35/S303 | 12 | 35 | 14,5 | 20 | 10,6 | 39,5 | 12 | 87 | 92 | 32,43 € |
| BAB12-40/S303 | 12 | 40 | 14,5 | 20 | 10,6 | 39,5 | 12 | 87 | 96 | 32,43 € |
| BAB12-45/S303 | 12 | 45 | 14,5 | 20 | 10,6 | 39,5 | 12 | 87 | 101 | 32,43 € |
| BAB12-50/S303 | 12 | 50 | 14,5 | 20 | 10,6 | 39,5 | 12 | 87 | 105 | 32,43 € |
| BAB12-60/S303 | 12 | 60 | 14,5 | 20 | 10,6 | 39,5 | 12 | 87 | 113 | 34,01 € |
| BAB12-70/S303 | 12 | 70 | 14,5 | 20 | 10,6 | 39,5 | 12 | 87 | 122 | 34,01 € |
| BAB12-80/S303 | 12 | 80 | 14,5 | 20 | 10,6 | 39,5 | 12 | 87 | 130 | 35,37 € |
| BAB16-30/S303 | 16 | 30 | 19,0 | 20 | 14,0 | 39,5 | 16 | 155 | 120 | 55,30 € |
| BAB16-35/S303 | 16 | 35 | 19,0 | 20 | 14,0 | 39,5 | 16 | 155 | 127 | 55,30 € |
| BAB16-40/S303 | 16 | 40 | 19,0 | 20 | 14,0 | 39,5 | 16 | 155 | 135 | 55,30 € |
| BAB16-45/S303 | 16 | 45 | 19,0 | 20 | 14,0 | 39,5 | 16 | 155 | 143 | 55,30 € |
| BAB16-50/S303 | 16 | 50 | 19,0 | 20 | 14,0 | 39,5 | 16 | 155 | 150 | 55,30 € |
| BAB16-60/S303 | 16 | 60 | 19,0 | 20 | 14,0 | 39,5 | 16 | 155 | 166 | 59,60 € |
| BAB16-70/S303 | 16 | 70 | 19,0 | 20 | 14,0 | 39,5 | 16 | 155 | 181 | 59,60 € |
| BAB16-80/S303 | 16 | 80 | 19,0 | 20 | 14,0 | 39,5 | 16 | 155 | 196 | 63,30 € |
| BAB20-60/S303 | 20 | 60 | 25,0 | 28 | 20,5 | 50,1 | 20 | 244 | 322 | 111,99 € |
| BAB20-80/S303 | 20 | 80 | 25,0 | 28 | 20,5 | 50,1 | 20 | 244 | 370 | 116,50 € |
| BAB20-100/S303 | 20 | 100 | 25,0 | 28 | 20,5 | 50,1 | 20 | 244 | 414 | 122,20 € |
| BAB20-120/S303 | 20 | 120 | 25,0 | 28 | 20,5 | 50,1 | 20 | 244 | 466 | 126,85 € |

Dimensions in mm

Our other products



RAG-12-M8
Roller guide
accessory, Anchoring
system

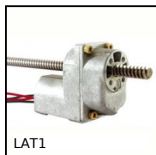

LAT1
1A motorised linear
actuator, 1 ampere



RVM14
Manual worm and
wheel gearbox,
Worm/wheel



SLB
Indexing plunger,
stainless steel



PNA_R
PERIFLEX elastic
coupling,
Replacement tyre



HTD5M_15
HTD Heavy duty
timing pulley, HTD5
Steel



PR85
Articulated foot Ø83,
Ø 83



DEP
Tools Hygienic Usit®
and Hygienic
Design®, Protective
insert for s...



BABPass
Hardened stainless
steel ball pin with
ring, With grip ring



ZDB
Machined plastic
bevel gear, 2:1



ZG0
Plastic spur gear,
Machined plastic
(delrin)



BOX-TOR-MAX
Box set of Nitrile O-
rings in nitrile, 2.90 x
1.78mm to 82.14 x
3.53

Complementary products



BABS
630 Stainless steel
compact ball pin,
Hardened stainless
steel

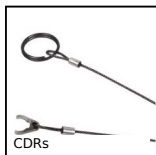

CDRs
Retaining cable for
ball pin, Retaining
cable