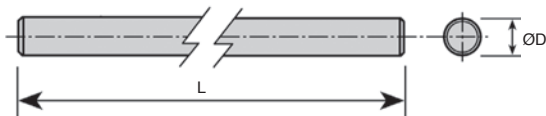

Recommended for use
with RJUM linear bearings

AWMP

- Shaft recommended for use with DryLin® RJUM bearings
- Material: Drawn aluminium AIMgSi0 5F22
- Linearity conforms to DIN EN574-3
- Hardness: 75HB
- Hard anodised surface
- Specific electric resistance: 4×10^{11} Ohm mm^2/m
- Chemical resistance: $2 < \text{pH} < 9$
- **Not compatible with linear ball bearings, see Z-A or Z-B shafts instead**

**DISCOUNTS**

Qty	1+	5+	10+	25+
Disc.	List -15%	List -20%	On request	On request

Part number	Version	Diameter ØD (mm)	Tolerance	Length L (mm)	Weight (kg/m)	Stock*	Price each 1 to 5
AWMP8-1000	Solid shaft	8	h8	1000	0,14	✓	20,42 €
AWMP10-1000	Solid shaft	10	h8	1000	0,22	✓	26,31 €
AWMP12-1000	Solid shaft	12	h8	1000	0,32	✓	32,78 €
AWMP16-1000	Solid shaft	16	h8	1000	0,57	✓	45,03 €
AWMP20-1000	Solid shaft	20	h8	1000	0,89	✓	61,10 €
AWMP25-1000	Solid shaft	25	h8	1000	1,41	✓	82,43 €
AWM30-1000	Hollow shaft	30x7,5	h10	1000	1,48	-	129,46 €
AWM40-1000	Hollow shaft	40x10	h10	1000	2,63	-	243,22 €
AWM50-1000	Hollow shaft	50x11	h10	1000	3,75	-	322,40 €

*Depending on availability - Dimensions in mm

Our other products



RPP

Connecting plate for RPP type timing belts, RPP14



EHD08-3

Internal epicyclic servo reducers, from 20 to 50 Nm



MPS

Hexagonal spacer, Stainless steel 303



PP60

Worm and wheel gear reducer, from 17.80 to 34 Nm



AC156-157

Strike for toggle latch, 25.5mm



PR105

Articulated foot Ø103, Ø 103



PSG15

Spur gear - precision range, Stainless steel 303



PO

Pull handle - Multi-sector, Tapped recessed insert



F7-P-AM

Multifunction display, Magnetic ring



T10_21_AL

T type timing pulley, Economy range - T10



gt64r

Rotating bent lever with spring, Increased



HG5-ECO

Eco range Spur gear, Steel C45

Complementary products



RJUM01

Closed polymer Drylin® R bearing, Drylin® R



FGWA

End support, With base



SFWR

End support, Surface mounting



RJUM05

Drylin® linear bearing housing, Closed - Slim