

Recommended for use  
with RJUM linear bearings

**AWMP**

- Shaft recommended for use with DryLin® RJUM bearings
- Material: Drawn aluminium AIMgSi0 5F22
- Linearity conforms to DIN EN574-3
- Hardness: 75HB
- Hard anodised surface
- Specific electric resistance:  $4 \times 10^{11}$  Ohm  $\text{mm}^2/\text{m}$
- Chemical resistance:  $2 < \text{pH} < 9$
- **Not compatible with linear ball bearings, see Z-A or Z-B shafts instead**

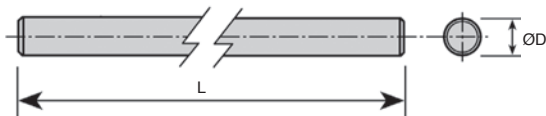

### DISCOUNTS

Qty	1+	5+	10+	25+
Disc.	List	-15%	-20%	On request

Part number	Version	Diameter ØD (mm)	Tolerance	Length L (mm)	Weight (kg/m)	Stock*	Price each 1 to 5
AWMP8-1000	Solid shaft	8	h8	1000	0,14	✓	20,42 €
AWMP10-1000	Solid shaft	10	h8	1000	0,22	✓	26,31 €
AWMP12-1000	Solid shaft	12	h8	1000	0,32	✓	32,78 €
AWMP16-1000	Solid shaft	16	h8	1000	0,57	✓	45,03 €
AWMP20-1000	Solid shaft	20	h8	1000	0,89	✓	61,10 €
AWMP25-1000	Solid shaft	25	h8	1000	1,41	✓	82,43 €
AWM30-1000	Hollow shaft	30x7,5	h10	1000	1,48	-	129,46 €
AWM40-1000	Hollow shaft	40x10	h10	1000	2,63	-	243,22 €
AWM50-1000	Hollow shaft	50x11	h10	1000	3,75	-	322,40 €

\*Depending on availability - Dimensions in mm

## Our other products

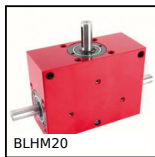

BLHM20

Right angled gearbox, double output shafts, up to 1.77 Nm



CHAGC-AL

Screw-in garnet hinge, Screw-on



PRS100

Stainless steel articulated foot  $\varnothing 100$ ,  $\varnothing 100$



FBL6000\_K1

Brush strip per meter PA6 fibres  $\varnothing 0.2$  to  $\varnothing 0.3$ , Black polyamide 6 -...



FBL4004\_K32

Brush strip per metre, Black striated polypropylene (PP)



P70

Worm and wheel gear reducer, up to 164 Nm



SH2

Parallel axis helical gear, Steel 20NCD2



AT5P\_AT10P

Connecting plate for AT type timing belts, AT10



MAX22

Motor-gearbox 12V and 24V DC, from



GCL

Linear ball slide - Stainless steel balls,



ACLEPP

Right angled bracket for aluminium profile,



BHEX

Hexagonal cap, Black technopolymer

## Complementary products



RJUM01

Closed polymer Drylin® R bearing, Drylin® R



FGWA

End support, With base



SFWR

End support, Surface mounting



RJUM05

Drylin® linear bearing housing, Closed - Slim