

Sta Diabolo shaped stainless steel anti vibration mount

Male / male mounting

AT-ZYss

- Radial elasticity greater than axial elasticity
- Works under both compression or shear
- Materials :
 - Core : Stainless steel (A2)
 - Cylinder : Rubber
- Hardness NK55-60 Shore A
- Working temp: -40°C to +70°C

Applications

- Dampening sound and vibrations



High flexibility

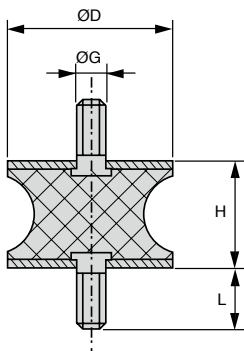

DISCOUNTS

Qty	1+	6+	20+	40+	100+
Disc.	List	-10%	-15%	-20%	On request

Part number	ØG	ØD	H	L	Stock*	Price each 1 to 5
AT-ZY4-10-10/SS	M4	10	10	10	✓	3,31 €
AT-ZY6-20-15/SS	M6	20	15	18	✓	4,95 €
AT-ZY6-20-30/SS	M6	20	30	12	-	5,51 €
AT-ZY6-25-20/SS	M6	25	20	18	-	5,51 €
AT-ZY8-30-20/SS	M8	30	20	20	✓	8,45 €
AT-ZY8-40-30/SS	M8	40	30	20	✓	14,92 €
AT-ZY8-40-48/SS	M8	40	48	23	✓	15,47 €
AT-ZY10-40-28/SS	M10	40	28	20	✓	14,92 €
AT-ZY10-46-25/SS	M10	46	25	20	-	17,67 €
AT-ZY10-50-30/SS	M10	50	30	33	✓	17,67 €

*Depending on availability - Dimensions in mm

Our other products



RJUM01
Closed polymer
Drylin® R bearing,
Drylin® R



ACAss
Stainless steel splined
shaft, Stainless steel



CHV
Mechanical speed
variator, from 0,18 to
1,5kW



BS3
Panamech, Multi-
Beam stainless steel,
Stainless steel - with
set screw



SHW
Plain washer, Steel



RJA00_28
Sealing strip, Clipping



PMB
Anti-vibration
machine mount, Oval
base plate



P55
Worm and wheel gear
reducer, up to 57 Nm

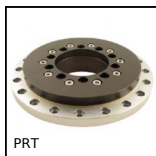

PRT
Rotary table iglidur®,
Iglidur®, aluminium



PLC_PLT
Magnetic stud with
threaded hole, With



DH
Dowel pin, Solid DIN
6325



TCL-ECL
Support rod for heavy
loads, Support spindle

Complementary products



ATZY
Diabolo shaped elasto
mount, Steel



CTZYSS
Stainless steel diabolo
shaped elasto mount,
Stainless steel



AZY
Cylindrical elasto
mount, Steel



DPAR_DKON
Progressive stop,
Steel