

Sta Diabolo shaped stainless steel anti vibration mount

Male / male mounting

AT-ZYss

- Radial elasticity greater than axial elasticity
- Works under both compression or shear
- Materials :
 - Core : Stainless steel (A2)
 - Cylinder : Rubber
- Hardness NK55-60 Shore A
- Working temp: -40°C to +70°C

Applications

- Dampening sound and vibrations

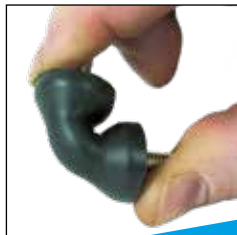

High flexibility

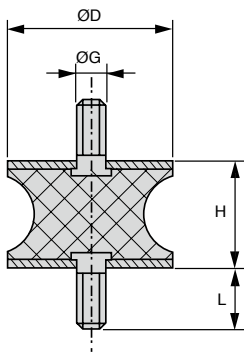

DISCOUNTS

Qty	1+	6+	20+	40+	100+
Disc.	List	-10%	-15%	-20%	On request

Part number	ØG	ØD	H	L	Stock*	Price each 1 to 5
AT-ZY4-10-10/SS	M4	10	10	10	✓	3,31 €
AT-ZY6-20-15/SS	M6	20	15	18	✓	4,95 €
AT-ZY6-20-30/SS	M6	20	30	12	-	5,51 €
AT-ZY6-25-20/SS	M6	25	20	18	-	5,51 €
AT-ZY8-30-20/SS	M8	30	20	20	✓	8,45 €
AT-ZY8-40-30/SS	M8	40	30	20	✓	14,92 €
AT-ZY8-40-48/SS	M8	40	48	23	✓	15,47 €
AT-ZY10-40-28/SS	M10	40	28	20	✓	14,92 €
AT-ZY10-46-25/SS	M10	46	25	20	-	17,67 €
AT-ZY10-50-30/SS	M10	50	30	33	✓	17,67 €

*Depending on availability - Dimensions in mm

Our other products



UCF_SS
Stainless steel flanged bearing, Stainless steel



PW_PWG15
Worm - precision range, Stainless steel



NDS14C
Angular connector, Universal angular connector



KB_OP
Open precision linear bearing, Precision - steel

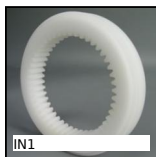

IN1
Internal gear, Machined plastic (delrin)



RJUM05
Drylin R® linear bearing housing, Closed - Slim



NTM
Nylon tipped set screw, Nylon-point



AC156-157
Strike for toggle latch, 25.5mm



CM_CO
Tools Hygienic Usit® and Hygienic



PRF_GAL
Roller for aluminium profile, Fixing kit for



RTL450
Self-centering locking assembly, High torque



BSB
Ballscrew bearing unit, Support

Complementary products



ATZY
Diabolo shaped elasto mount, Steel



CTZYSS
Stainless steel diabolo shaped elasto mount, Stainless steel



AZY
Cylindrical elasto mount, Steel



DPAR_DKON
Progressive stop, Steel