

Diabolo-shaped elasto mount

Ste Stock

AT-ZY

Male / male mounting

- Radial elasticity greater than axial elasticity
- Cylinder worked under compression or shearing
- Materials:
 - core: Steel plates
 - cylinder: Rubber
- Hardness: NK 55-60 shore A
- Working temp: -40°C to +70°C



Uses

- Dampens sound and vibrations



High flexibility

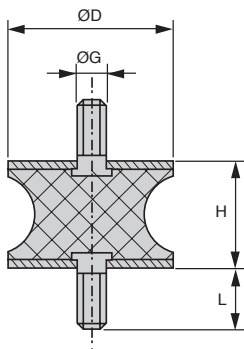

DISCOUNTS

Qty	1+	6+	20+	40+	100+	200+
Disc.	List	-10%	-15%	-20%	-25%	On request

Part number	$\varnothing G$	$\varnothing D$	H	L	Stock*	Price each 1 to 5
AT-ZY4-10-10	M4	10	10	10	✓	1,85 €
AT-ZY6-20-15	M6	20	15	18	✓	3,71 €
AT-ZY6-20-30	M6	20	30	12	✓	3,71 €
AT-ZY6-25-20	M6	25	20	12	✓	3,99 €
AT-ZY8-30-20	M8	30	20	20	✓	5,45 €
AT-ZY8-40-30	M8	40	30	20	✓	7,30 €
AT-ZY8-40-48	M8	40	48	23	✓	10,98 €
AT-ZY10-40-28	M10	40	28	20	-	8,08 €
AT-ZY10-46-25	M10	46	25	20	-	11,77 €
AT-ZY10-50-30	M10	50	30	33	✓	13,45 €
AT-ZY12-75-40	M12	75	40	37	-	20,20 €
AT-ZY16-100-55	M16	100	55	45	-	66,95 €

*Depending on availability - Dimensions in mm

Our other products



Worm and wheel set,
Bronze



Revolving handle for
handwheel, Fixed

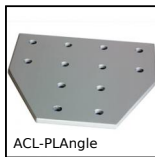

Joining plate for
aluminium profile,
Angle connection



Pull handle - Multi-
sector, Tapped
recessed insert



Hexagonal spacer,
Stainless steel 303



Standard stainless
steel profile, 45 x 45
mm



Worm and wheel gear
reducer, up to 196
Nm



Catch-plate for latch,
Catch-plate



Right angled gearbox,
from 0.66 to 1.77 Nm



Parallel axis helical
gear, Machined plastic



Internal gear, Steel
20NCD2



Chain link, Steel

Complementary products



Stainless steel diabolo
shaped elasto mount,
Stainless steel



Diabolo shaped elasto
mount, Steel



Cylindrical elasto
mount, Steel



Cylindrical elasto
mount, Steel