

AT type tooth bar stock



AT5-BAR

Aluminium



- Bar stock to be cut to length by the customer
- The overall length is the same as the maximum length
- Material : Aluminium suitable for hard anodic oxidation
- Finish : Supplied not-treated

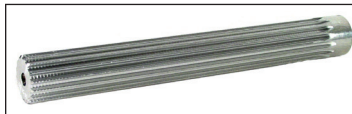

Info.

- We are unable to modify this product

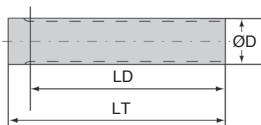

DISCOUNTS

Qty	1+	2+	4+
Disc.	List	-20%	On request

Part number	Z Teeth	ØD External	Length of teeth L _D	Total length L _T	Price each
12AT5-BAR	12	17,85	140	140	9,45 €
13AT5-BAR	13	19,45	140	140	19,64 €
14AT5-BAR	14	21,05	140	140	11,13 €
15AT5-BAR	15	22,65	140	140	12,05 €
16AT5-BAR	16	24,20	140	140	13,57 €
18AT5-BAR	18	27,40	140	140	15,75 €
19AT5-BAR	19	29,00	140	140	17,04 €
20AT5-BAR	20	30,60	160	160	19,64 €
21AT5-BAR	21	32,30	160	160	20,47 €
22AT5-BAR	22	33,85	160	160	22,81 €
23AT5-BAR	23	35,45	160	160	23,01 €
24AT5-BAR	24	37,00	160	160	24,72 €
25AT5-BAR	25	38,55	160	160	26,57 €
26AT5-BAR	26	40,20	160	160	29,26 €
28AT5-BAR	28	43,25	160	160	32,42 €
30AT5-BAR	30	46,55	160	160	34,74 €
32AT5-BAR	32	49,70	160	160	40,31 €
34AT5-BAR	34	52,85	160	160	44,15 €
36AT5-BAR	36	56,05	160	160	46,84 €
38AT5-BAR	38	59,25	160	160	49,71 €
40AT5-BAR	40	62,45	160	160	53,92 €
42AT5-BAR	42	65,60	160	160	58,32 €
44AT5-BAR	44	68,80	160	160	68,68 €
46AT5-BAR	46	72,00	160	160	69,16 €
48AT5-BAR	48	75,15	160	160	77,36 €
52AT5-BAR	52	81,55	160	160	106,18 €
56AT5-BAR	56	87,90	160	160	109,65 €
60AT5-BAR	60	94,25	160	160	116,26 €
64AT5-BAR	64	100,65	160	160	155,16 €
72AT5-BAR	72	113,35	160	160	163,49 €

Dimensions in mm

Our other products



PSG15
Spur gear - precision range, Stainless steel 303

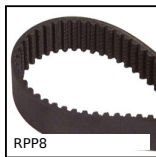

RPP8
RPP heavy duty timing belt, RPP8



EFSM
Igubal® flange bearing, Polymer



DOMI50
Accessories, Plate



CHN_CHNSS
Straight long link stainless steel chain, Stainless steel



CHAFR
Adjustable friction hinges, Friction



AT5-16ECO
AT type timing pulley, Economy range - AT5 aluminium



PTA100
Articulated levelling foot, pressed base Ø100, Ø 100



BOX-TOR-INCH
Box set of Nitrile O-rings in inch NBR90Sh A, For fasteners and



CHMR40
Worm and wheel gear reducer, up to 57 Nm



BDM
Pin for magnetic bush, Fast and light magnetic locking



E60B
Right angle helical reducers, from 4.50 to 24 Nm

Complementary products



AT10-BAR
AT type tooth bar stock, AT10



AT5-10ECO
AT type timing pulley, Economy range - AT5 aluminium



AT5-16ECO
AT type timing pulley, Economy range - AT5 aluminium



AT5-25ECO
AT type timing pulley, Economy range - AT5 aluminium