

- Bar stock to be cut to length by the customer
- The overall length is the same as the maximum length
- Material : Aluminium suitable for hard anodic oxidation
- Finish : Supplied not-treated

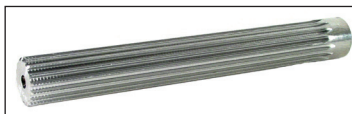

### Info.

- We are unable to modify this product

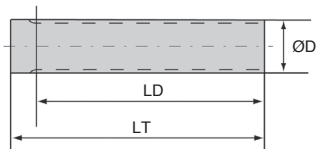

### DISCOUNTS

Qty	1+	2+	4+
Disc.	List	-20%	On request

Part number	Z Teeth	ØD External	Length of teeth L <sub>D</sub>	Total length L <sub>T</sub>	Price each
15AT10-BAR	15	45,90	160	160	30,93 €
16AT10-BAR	16	49,14	160	160	35,15 €
18AT10-BAR	18	55,45	160	160	42,21 €
19AT10-BAR	19	58,65	160	160	47,31 €
20AT10-BAR	20	61,80	160	160	51,41 €
21AT10-BAR	21	65,00	160	160	55,66 €
22AT10-BAR	22	68,20	160	160	65,98 €
23AT10-BAR	23	71,35	160	160	66,28 €
24AT10-BAR	24	74,55	160	160	74,32 €
25AT10-BAR	25	77,75	160	160	74,88 €
26AT10-BAR	26	80,90	160	160	83,42 €
28AT10-BAR	28	87,25	160	160	92,83 €
30AT10-BAR	30	93,65	160	160	112,55 €
32AT10-BAR	32	100,00	160	160	123,56 €
34AT10-BAR	34	106,40	160	160	135,20 €
36AT10-BAR	36	112,75	160	160	148,54 €
38AT10-BAR	38	119,10	160	160	172,13 €
40AT10-BAR	40	125,45	160	160	185,77 €
42AT10-BAR	42	131,85	160	160	210,24 €
44AT10-BAR	44	138,20	160	160	230,17 €
46AT10-BAR	46	144,55	160	160	247,96 €
48AT10-BAR	48	150,95	160	160	262,35 €
52AT10-BAR	52	163,65	160	160	317,75 €
56AT10-BAR	56	176,40	160	160	365,45 €
60AT10-BAR	60	189,15	160	160	432,22 €

Dimensions in mm

## Our other products



PSEC  
Security pull handle,  
Thermoplastic



CHM50  
Worm and wheel gear  
reducer, up to 107  
Nm



LINK64  
Synchronous AC  
Motor and- gearbox ,  
from 1.3 to 6Nm



ADSR  
Backlash free  
coupling Gerwah® ,  
from 12.5 to 525Nm



MEB  
Moulded plastic bevel  
gear (nylon), 1:1



CLB\_T  
Die cast zinc clamping  
lever - male, Zamak



DOMI30  
Accessories, Plate



LRR  
Catch-plate for latch,  
Catch-plate



BLHT60  
Right angled gearbox,  
from 26 to 70 Nm



RFK38C  
Hypoid gearbox -  
Stainless steel, up to  
200 Nm



PCS25ECO  
Chain sprocket - steel,  
6.35mm



RPCplss  
Swivel castor with  
double brake,  
Stainless steel -  
Polyamide

## Complementary products



AT5-BAR  
AT type tooth bar  
stock, AT5



AT10-25ECO  
AT type timing pulley,  
Economy range -  
AT10 aluminium



AT10-32ECO  
AT type timing pulley,  
Economy range -  
AT10 aluminium



AT10-50ECO  
AT type timing pulley,  
Economy range -  
AT10 aluminium