

# Locking pin with interlocking safety latch

Steel

AFSE

- Allows easy and quick location of parts or workpieces requiring assembly

- Material:

Galvanized steel

## Advantages

- The interlocking safety latch allows components with a large cross sectional area to be secured together
- In addition they absorb any axial movement
- Indexing slots in the safety latch are used to locate the "Closed" and "Open" position

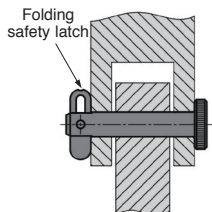

Typical application

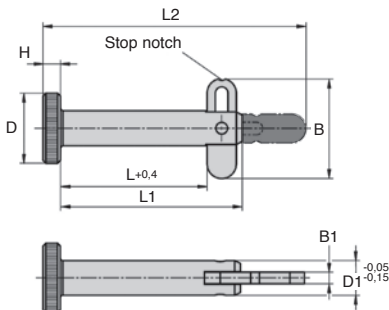

## DISCOUNTS

Qty	1+	6+	10+	25+
Disc.	List	-5%	-10%	On request

Part number	ØD	ØD1	L	L1	L2	H	B	B1	Mounting hole H11	Shearing force		Price each 1 to 5
										double section max (kN)	Extraction force (N)	
AFSE6-25	12	6	25	31	45	3	16,9	2	6	12	190	15,42 €
AFSE6-40	12	6	40	46	60	3	16,9	2	6	12	190	15,75 €
AFSE6-50	12	6	50	56	70	3	16,9	2	6	12	190	16,23 €
AFSE8-25	16	8	25	31	46	4	16,9	2	8	21	270	16,23 €
AFSE8-40	16	8	40	46	61	4	16,9	2	8	21	270	16,71 €
AFSE8-50	16	8	50	56	71	4	16,9	2	8	21	270	17,01 €

Dimensions in mm

Fax **0 825 88 6000**  
Service 0,15 € / min  
+ prix appel

## Our other products



SVR15

Screwjack with travelling nut, with moving nut



JCSs

Single stainless steel universal joint, Low duty



BSPM

Miniature ballscrew,

Nut+rolled ballscrew



PRF\_ECL

Nut for aluminium profile, Stainless steel square nut with tab



RTL450

Self-centering locking assembly, High torque



SH1

Parallel axis helical gear, Steel 20NCD2



GPB

Threaded spherical knob, With brass insert



CHAEpac

Square decorative screwed hinges, carbon fibre reinforced



INS\_BR

Self tapping brass insert, Brass



PSG3

Spur gear - precision range, Case hardened steel 20NCD2



M0

Worm and wheel set, Bronze



CHA138

Screwed hinge with threaded insert, 138 degrees

## Complementary products



BAB

Hardened Stainless steel ball pin, Stainless steel hardened



BABS

630 Stainless steel compact ball pin, Hardened stainless steel



BABT

Hardened Stainless steel ball pin, Hardened stainless steel



BABreglable

Adjustable ball pin hardened stainless steel, adjustable