



# Latch for aluminium profiles

## Spring operated latch

## ACLLPP

### - Spring operated latch for aluminium profiles

#### - Material

Body : Zamak

Handle : Black nylon

Nut : Stainless steel

### Advantages

- Suitable for PRF aluminium profiles

- Mounts in any position

### Info

- No mounting screws supplied (see PRF-ECL-M6 and BHC6)

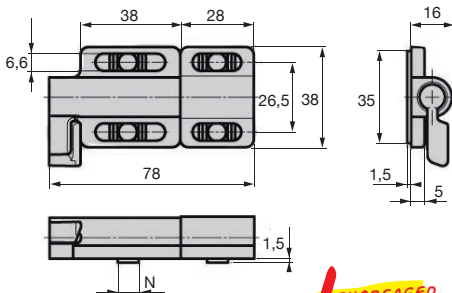

**INCREASED STOCK**

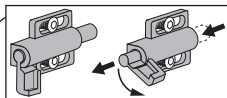
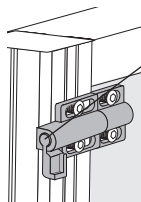
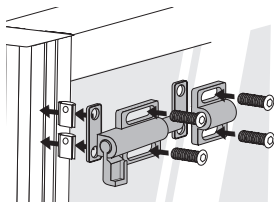

### DISCOUNTS

Qty	1+	50+	100+
Disc.	List	-5%	On request

Part number	N	Weight (g)	Stock*	Price each 1 to 49
ACL-LPP-78	8-10	120	✓	16,46 €

\* Depending on availability - Dimensions in mm

## Our other products



HEAVY DUTY spur gear, Steel 35NCD6



Spur gear - precision range, Case hardened steel 20NCD2



Suction cup threaded insert, Insert for suction cup - Socket screw

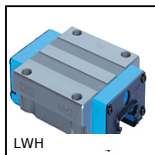

High rigidity linear slide, Chariot - from 9320 N to 71300 N



Adjustment bushing for half-rail guide, Adjustment bushing



Storage bin, 8mm



Die cast zinc clamping lever - male, Zamak



Stainless steel bow shackle with eye bolt, Stainless steel



Automatic chain tensioner, With stainless steel



Anchoring bracket for aluminium profile, Anchor



Square tube connector, Fixed angle



Anti-vibration machine mount, Oval base plate

## Complementary products



Standard aluminium profile, 45 x 45 mm



Nut for aluminium profile, Steel square nut with tab