

# Floor anchor for aluminium profiles



## ACLEFS

## Right angled floor anchor

- For securing aluminium profiles to a floor

- Material :  
Zamak

### Advantages

- Suitable for use with PRF aluminium profiles
- Only for use with profiles wider than 40mm

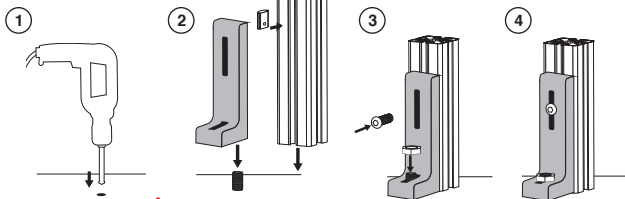
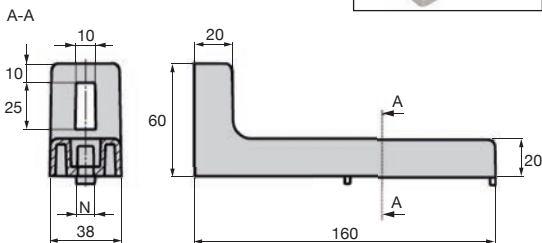

**INCREASED STOCK**

### DISCOUNTS

Qty	1+	50+	100+
Disc.	List	-5%	On request

Part number	N	Weight (g)	Stock*	Price each 1 to 49
ACL-EFS-160	8	110	✓	11,36 €

Dimensions in mm



# Floor anchor for aluminium profiles

## Adjustable height floor anchor **ACLEFS/A**

- For securing aluminium profiles to a floor

Material:  
Zamak

### Advantages

- Adjustable
- Suitable for use with PRF aluminium profiles

**Adjustable**

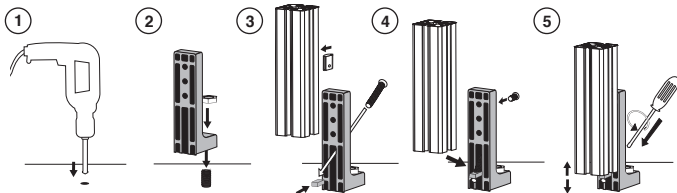
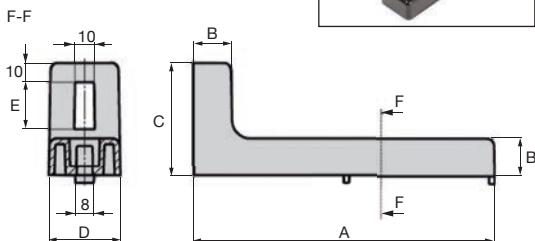

**INCREASED STOCK**

### DISCOUNTS

Qty	1+	50+	100+
Disc.	List	-5%	On request

Part number	Profile size (mm)	A	B	C	D	E	Max height	Masse (g)	Stock*	Price each 1 to 49
ACL-EFS-120/A	30 mini	120	15	45	28	19	52	88	✓	12,72 €
ACL-EFS-160/A	40 mini	160	20	60	38	29	72	120	✓	17,58 €

Dimensions in mm

## Our other products

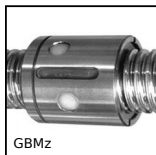

GBMz

Cylindrical ballscrew nut, Cylindrical nut - Multiple starts



S\_2RS

Deep groove ball bearing, Stainless steel



AT10-32ECO

AT type timing pulley, Economy range - AT10 aluminium



PRF\_BR

Clamp for aluminium profile, Clamp for profile



STC

Shock Absorber - stop collar, Universal flange



PRF\_JL6

Lip seal for panel, Door seal - Ø 6mm



PCS6ECO

Chain sprocket - steel, 6mm (DIN 04-1)



PRF4545\_P

Stripp Aluminium profile with extendable slot, 45 x 45 mm



GPB

Threaded spherical knob, With brass insert



F7-I

Multifunction display, With internal sensor



E50

Right angle helical reducers, from 3 to 41 Nm



PSG3

Spur gear - precision range, Case hardened steel 20NCD2

## Complementary products



PRF4545

Standard aluminium profile, 45 x 45 mm