

Spherical ended stop for alu. profiles

ACLBS

Clip-in mounting

- **Rapid closing mechanism for doors**
- **Material**
Black glass fibre reinforced nylon

Advantages

- Suitable for PRF aluminium profiles
- Mounts in any position

Info

- No mounting screws supplied (see PRF-ECL-M6 and BHC6)

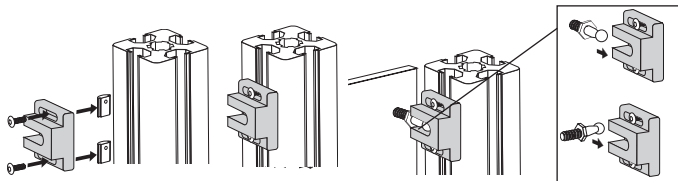
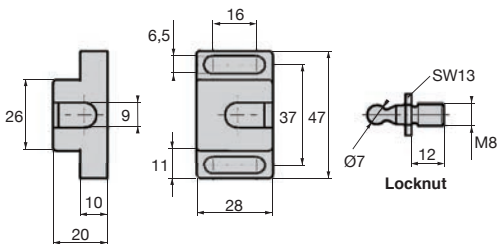

INCREASED STOCK

DISCOUNTS

Qty	1+	50+	100+
Disc. List		-5%	On request

Part number	Locknut	Retaining force (N)	Weight (g)	Stock*	Price each 1 to 49
ACL-BTS-40/ZN	Chromed	40	45	✓	4,78 €
ACL-BTS-40/SS	Stainless steel 304	40	45	✓	7,18 €
ACL-BTS-50/ZN	Chromed	50	45	✓	4,78 €
ACL-BTS-50/SS	Stainless steel 304	50	45	✓	7,18 €

* Depending on availability - Dimensions in mm

Closing system for use with alu. profiles

Accessories for spherical end stop **ACLBS**

- Right angled bracket and spacer for fast closing mechanism

Advantages

- Suitable for PRF aluminium profiles
- Mounts in any position

Info

- No mounting screws supplied (see PRF-ECL-M6 and BHC6)
- Not sold individually, contact us for details



ACL-BTS-ET



ACL-BTS-EQ

 **INCREASED STOCK**

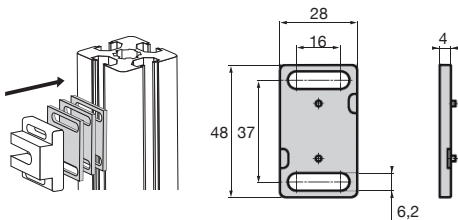

ACL-BTS-ET

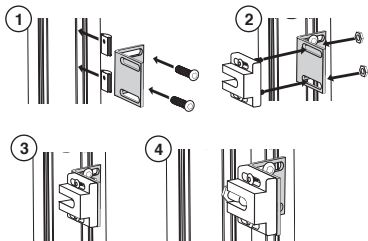

ACL-BTS-EQ

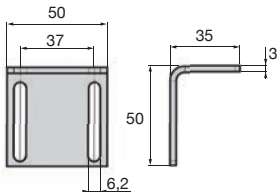

DISCOUNTS

Qty	1+	50+	100+
Disc.	List	-5%	On request

Part number	Version	Material	Weight (g)	Stock*	Price each 1 to 49
ACL-BTS-ET	Spacer	Nylon	5	✓	0,44 €
ACL-BTS-EQ	90° bracket	Chromed steel	72,4	✓	2,66 €

* Depending on availability - Dimensions in mm

Our other products



LRX
Linear roller slide, Rail
- from 9410 N to
101000 N



P20
Worm and wheel gear
reducer, up to 5 Nm



AT10-50ECO
AT type timing pulley,
Economy range -
AT10 aluminium



BLHT70
Right angled gearbox,
from 26 to128 Nm



HW_HT
Half-rail guide, Wheel



GMK17_BR
Clamp for guiding
profile, Rounded only
- double



PCS_PA6
Plastic sprocket,
9.525mm (DIN 06B-1)



VHEH
Hexagonal headed
screw with collar
Hygienic Usit®,
Stainless steel



RT70
Self-centering locking
Assembly,
Medium/high torque



SDC
Positioning sleeve for
indexing pin, For pin
Ø4 to Ø12



J64
Spur gear coaxial
gearbox, from 0.57 to
2.25 Nm - In-line



CHINV2
Invisible hinge,
Invisible - Opening up
to 125°

Complementary products



PRF4545
Standard aluminium
profile, 45 x 45 mm



ACLBS
Spherical ended stop
for aluminium profile,
Spherical ended stop