

Stainless steel 304 splined shaft

ACAss

Parallel-faced

- Suitable for transmitting high torque values

- Material:

Stainless steel 304 (1.4301)

Accessoires

- Stainless steel splined bush BCAss

Option

- Alternative lengths up to 3000mm

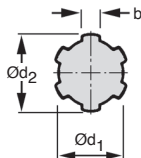
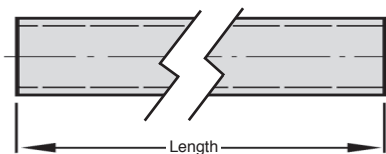

For hostile environments

NEW!
Replace the part
number BUC30

DISCOUNTS

Qty	1+	2+	20+
Disc.	List	-10%	On request

Part number	Number of splines	$\overset{+0}{\underset{-0,08}{\text{Ød1}}}$	$\overset{-0,07}{\underset{-0,27}{\text{Ød2}}}$	$\overset{+0}{\underset{-0,08}{\text{b}}}$	Standard length (mm)	Weight (kg/m)	Price each for 1000mm
ACA6-14-1000/SS	6	11,00	14,00	3,00	1000	0,949	57,56 €
ACA6-16-1000/SS	6	13,00	16,00	3,50	1000	1,287	67,43 €
ACA6-20-1000/SS	6	16,00	20,00	4,00	1000	1,911	119,37 €
ACA6-25-1000/SS	6	21,00	25,00	5,00	1000	3,139	195,47 €
ACA6-32-1000/SS	6	26,00	32,00	6,00	1000	5,008	299,45 €
ACA8-38-1000/SS	8	32,00	38,00	6,00	1000	7,433	429,45 €

Dimensions in mm

Our other products



EBC
Cap nut Hygienic Design®, Compact



PFL
P-FLEX Coupling, Set screw



BLH60
Right angled gearbox, from 19 to 70 Nm



BTC
End cap for square tube, Standard



PT881
Drive sprocket for slat top chain, Range 881



EHD04
Internal epicyclic servo reducers, from 3.4 to 7 Nm



VTLF
3 lobed handle, Polyamide - Brass



MEP
Revolving handle for handwheel, Fixed



B_ECO
Eco. range steel bevel gear, 1:1



PR85
Articulated foot Ø83, Ø 83



Q6
Deep groove ball bearing, Steel

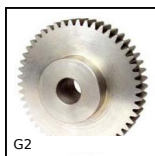

G2
Steel spur gear, Steel 20NCD2

Complementary products



BCAss
Stainless steel splined bush, Inox



ACA
Steel splined shaft, Steel