

Stainless steel 304 splined shaft

ACAss

Parallel-faced

- Suitable for transmitting high torque values

- Material:

Stainless steel 304 (1.4301)

Accessoires

- Stainless steel splined bush BCAss

Option

- Alternative lengths up to 3000mm

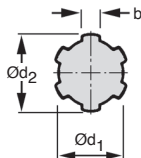
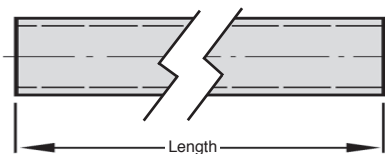

For hostile environments

NEW!
Replace the part
number BUC30

DISCOUNTS

Qty	1+	2+	20+
Disc.	List	-10%	On request

Part number	Number of splines	$\varnothing d_1^{+0/-0,08}$	$\varnothing d_2^{-0,07/-0,27}$	$b^{+0/-0,08}$	Standard length (mm)	Weight (kg/m)	Price each for 1000mm
ACA6-14-1000/SS	6	11,00	14,00	3,00	1000	0,949	57,56 €
ACA6-16-1000/SS	6	13,00	16,00	3,50	1000	1,287	67,43 €
ACA6-20-1000/SS	6	16,00	20,00	4,00	1000	1,911	119,37 €
ACA6-25-1000/SS	6	21,00	25,00	5,00	1000	3,139	195,47 €
ACA6-32-1000/SS	6	26,00	32,00	6,00	1000	5,008	299,45 €
ACA8-38-1000/SS	8	32,00	38,00	6,00	1000	7,433	429,45 €

Dimensions in mm

Our other products



Slim slat top chain acetal, Narrow straight range 820



Hypoid gearbox - Stainless steel, up to 200 Nm



Cam latch, Cam latch



Topball self-aligning linear bearing, Topball self-aligning



Square tube connector, Fixed angle



Rotex® GS backlash free jaw coupling, from 0.5 to 190Nm



Powercoil thread inserts, Kit Powercoil - with or without insertion ...



Parallel axis helical gear, Steel 20NCD2



Pull handle - Multi-sector, Tapped



Spur gear - precision range, Stainless steel



Miniature friction hinge, Friction



Articulated foot Ø40, Ø 40

Complementary products



Stainless steel splined bush, Inox



Steel splined shaft, Steel