

- Closed by latching
- Materials:
White zinc plated steel
18/8 stainless steel, natural finish

Accessory

- GP75-ZB and GP75-SS toggle latches

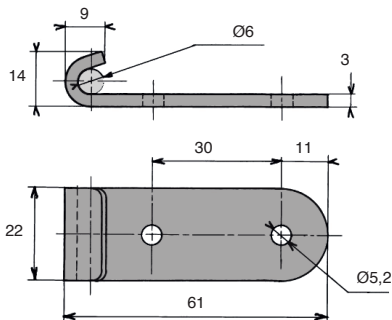

DISCOUNTS

Qty	1+	51+	101+	250+	400+
Disc.	List	-10%	-15%	-20%	On request

Part N°	Material	Suitable for latch	Weight (g)	Stock*	Price each 1 to 50
Flat					
AC144-ZB	Steel	GP75-ZB	35	-	0,86 €
AC144-SS	Stainless steel	GP75-SS	35	✓	2,74 €

All dimensions in mm

Our other products



Sealed flange bearing unit for Food Industry, cover



Spherical bushing, Steel / steel



Eco range Spur gear, Steel C45



Toggle latches, Standard



Worm and wheel set, Machined plastic (delrin)



Mini plain bearing ball transfer unit, For countersinking



Telescopic drawer,



Igubal® pillow block bearing, Polymer

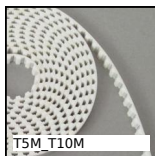

T type timing belt per metre, T10 Steel cored polyurethane



PERIFLEX® elastic coupling, Complete coupling



Worm and wheel set, Hardened steel



Invisible hinge, Invisible - Opening up to 90°

Complementary products



Spring loaded toggle latch, Standard (GP75)



Strike for toggle latch, 15mm



Strike for toggle latch, 12,13,18 and 20mm