

Stainless steel swivelling foot

Mounting instructions

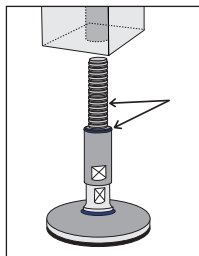

Grease the seal and thread with food-grade grease

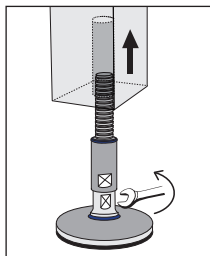

Set the height of the foot by adjusting the screw (whilst not attached to the machine)

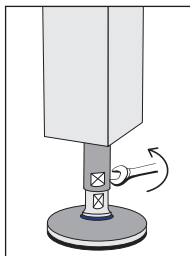

Adjust the sleeve in order to bring the upper seal into contact with the bottom of the machine

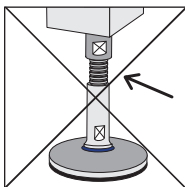

The thread must be completely covered by the sleeve

Advice on cleaning

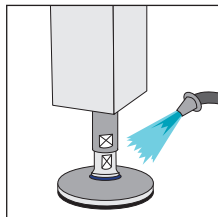

Rinse with water (Max. temperature 40°C)

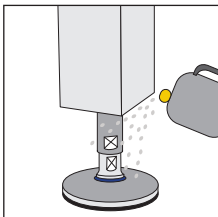

Apply an alkaline detergent (Max. temperature 90°C) and leave to act for 10 min

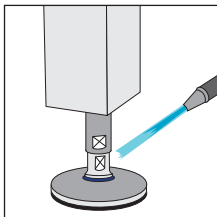

Rinse with water at 8-12 bar (max. 100°C) using a jet inclined at 45° at a minimum distance of 300 mm to avoid damage to the seals