

# Tightening washer

## WTM

## Hardened steel

- **Heavy duty clamping washer**
- Conforms to DIN 6340
- Materials :  
Steel AlZnMgCu0.5F47  
resistance hardened 1200-1400/mm<sup>2</sup>

### Info.

- **Not sold individually, please contact us for details**



Tight  
locking

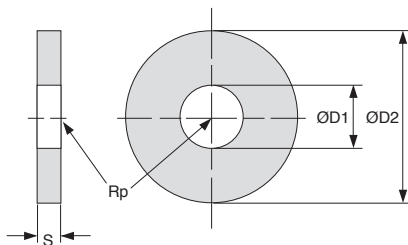
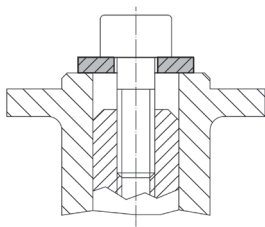

### DISCOUNTS

Qty	1+	20+	50+
Disc.	List	-10%	On request

Part number	ØD1	ØD2	S	For screw	Weight (g)	Stock*	Price each 1 to 19
WTM-6	6,4	17	3	M6	3,8	✓	0,79 €
WTM-8	8,4	23	4	M8	9,8	✓	0,79 €
WTM-10	10,5	28	4	M10	14	✓	0,98 €
WTM-12	13,0	35	5	M12	28	✓	1,29 €
WTM-16	17,0	45	6	M16	55	✓	1,84 €
WTM-20	21,0	50	6	M20	71	✓	2,91 €
WTM-24	25,0	60	6	M24	122	-	4,55 €

\*Subject to availability - Dimensions in mm

HPC

WEB  
04/2020

www.hpceurope.com

Tél: 0 825 88 5000 Service 0,15 €/min + prix appel