

- Handwheel (only)
- Conforms to DIN950
- Versions with and without DIN6885-1 keyways
- Material:  
Stainless steel 1.4401 (316)  
Finish: turned and polished

316 stainless steel



### Accessory

- HLUMSS rotating handle

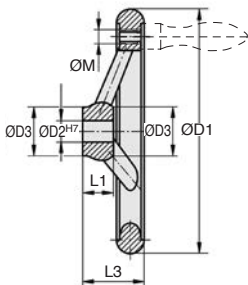
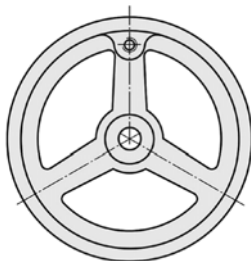
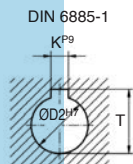

### DISCOUNTS

Qty	1+	3+	5+	10+
Disc.	List	-5%	-10%	On request

Part N°	ØD1	ØD2	ØD3	L1	L3	M	K	T	N° of spokes	Price each 1 to 2
<b>No keyway</b>										
HLU100-10/SS	100	10	26	17	33	M6	-	-	3	52,98 €
HLU125-12/SS	125	12	28	18	36	M8	-	-	3	75,98 €
HLU140-14/SS	140	14	30	19	39	M8	-	-	3	98,03 €
HLU160-16/SS	160	16	32	20	40	M10	-	-	3	112,01 €
HLU200-18/SS	200	18	38	24	45	M10	-	-	3	196,63 €
<b>With keyway</b>										
HLU100-10K/SS	100	10	26	17	33	M6	3	11,4	3	55,64 €
HLU125-12K/SS	125	12	28	18	36	M8	4	13,8	3	78,65 €
HLU140-14K/SS	140	14	30	19	39	M8	5	16,3	3	100,72 €
HLU160-16K/SS	160	16	32	20	40	M10	5	18,3	3	114,68 €
HLU200-18K/SS	200	18	38	24	45	M10	6	20,8	3	200,56 €

All dimensions in mm