

# Latch clamp with lock

## GAC

## Lockable

- Snap closing
- Supplied with 2 identical keys
- Latch clamp and strike plates supplied separately
- Material:  
Galvanised steel

### Advantage

- Can be locked using a key

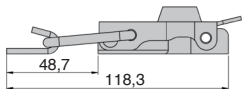
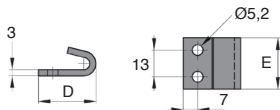
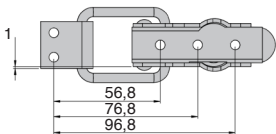
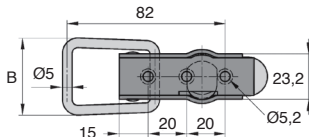
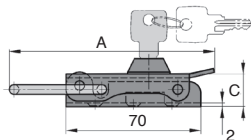
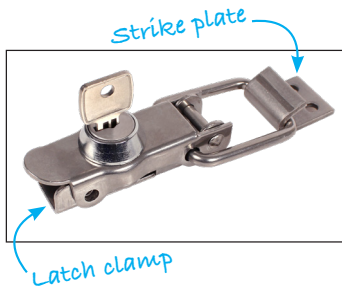

Hole layout

### DISCOUNTS

Qty	1+	10+	20+	50+	100+
Disc	List	-3%	-5%	-10%	On request

Part number	Material	Finish	A	B	C	D	E	Weight (g)	Price each
									Stock*
<b>Latch clamp</b>									
GAC-106	steel	Galvanized	106,5	40,0	17,0	-	-	132	✓ 17,94 €
<b>Strike plate</b>									
GAC-106G	steel	Galvanized	-	-	-	28	25	24	✓ 3,81 €

\*Depending on availability - Dimensions in mm