

Quarter turn latch for **the food industry**

Key

SER69K

- Key for SER69K stainless steel 1/4 turn latch

- 2 versions:

Clé-T in plastic with triangular head

Clé-R in plastic with stainless steel insert,
rounded head

Advantages

- Ideal for use in the food industry

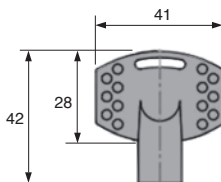

SER69K-CLE-T

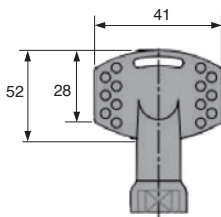
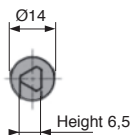

SER69K-CLE-R

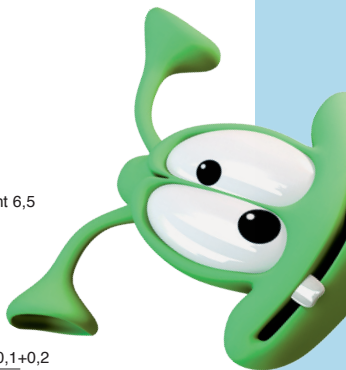
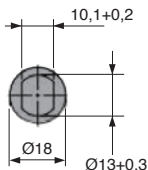

DISCOUNTS

Qty	1+	6+	10+	15+
Disc. List	-5%	-10%	On request	

Part number	Drive	Material	Price each 1 to 5
SER69K-CLE/T	Triangular	Plastic	2,48 €
SER69K-CLE/R	Rounded	Plastic, stainless steel insert	6,25 €

All dimensions in mm

0 825 88 6000
Service 0,15 € / min
+ prix appel

cial2@hpceurope.com

HPC SUPPLEMENT 2019

77