

# Bearing locknut



## KM

## To be used with MB washers

- Frequently used when mounting bearings
- To be used with MB washers
- Absolutely secure, not removable
- Requires machining of keyway in threaded part of the shaft
- Material: steel

For axial locking



### Accessories

- MB washer

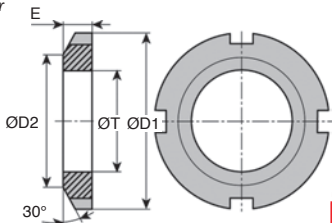

Until  
**-30%\***

### DISCOUNTS

Qty	1+	10+	20+	50+
Disc.	List	-30%	-50%	On request

Part number	For washer	Thread	ØT	ØD1	ØD2	E	Weight (g)	Stock*	Price each 1 to 9
KM3	MB3	M17x1,0	28	24	5	13	✓	2,18 €	
KM4	MB4	M20x1,0	32	26	6	19	✓	1,79 €	
KM5	MB5	M25x1,5	38	32	7	25	✓	2,85 €	
KM6	MB6	M30x1,5	45	38	7	43	✓	2,36 €	
KM7	MB7	M35x1,5	52	44	8	53	✓	3,48 €	
KM8	MB8	M40x1,5	58	50	9	85	✓	4,42 €	
KM9	MB9	M45x1,5	65	56	10	120	✓	4,42 €	
KM10	MB10	M50x1,5	70	61	11	150	✓	4,91 €	
KM11	MB11	M55x2,0	75	67	11	160	✓	6,07 €	
KM12	MB12	M60x2,0	80	73	11	170	✓	6,38 €	
KM13	MB13	M65x2,0	85	79	12	200	✓	8,57 €	
KM14	MB14	M70x2,0	92	85	12	240	-	9,24 €	
KM15	MB15	M75x2,0	98	90	13	290	-	9,73 €	
KM16	MB16	M80x2,0	105	95	15	400	✓	12,59 €	
KM17	MB17	M85x2,0	110	102	16	450	-	15,45 €	
KM18	MB18	M90x2,0	120	108	16	560	-	17,86 €	
KM19	MB19	M95x2,0	125	113	17	660	-	18,17 €	
KM20	MB20	M100x2,0	130	120	18	700	-	22,59 €	
KM22	MB22	M110x2,0	145	133	19	970	-	27,69 €	
KM24	MB24	M120x2,0	155	138	20	1080	-	37,42 €	
KM26	MB26	M130x2,0	165	149	21	1250	-	48,05 €	
KM28	MB28	M140x2,0	180	160	22	1560	-	53,90 €	
KM30	MB30	M150x2,0	195	171	25	2030	-	61,63 €	

\*Depending on availability - Dimensions in mm